

## GB Fitting Instructions for Basic Carrier

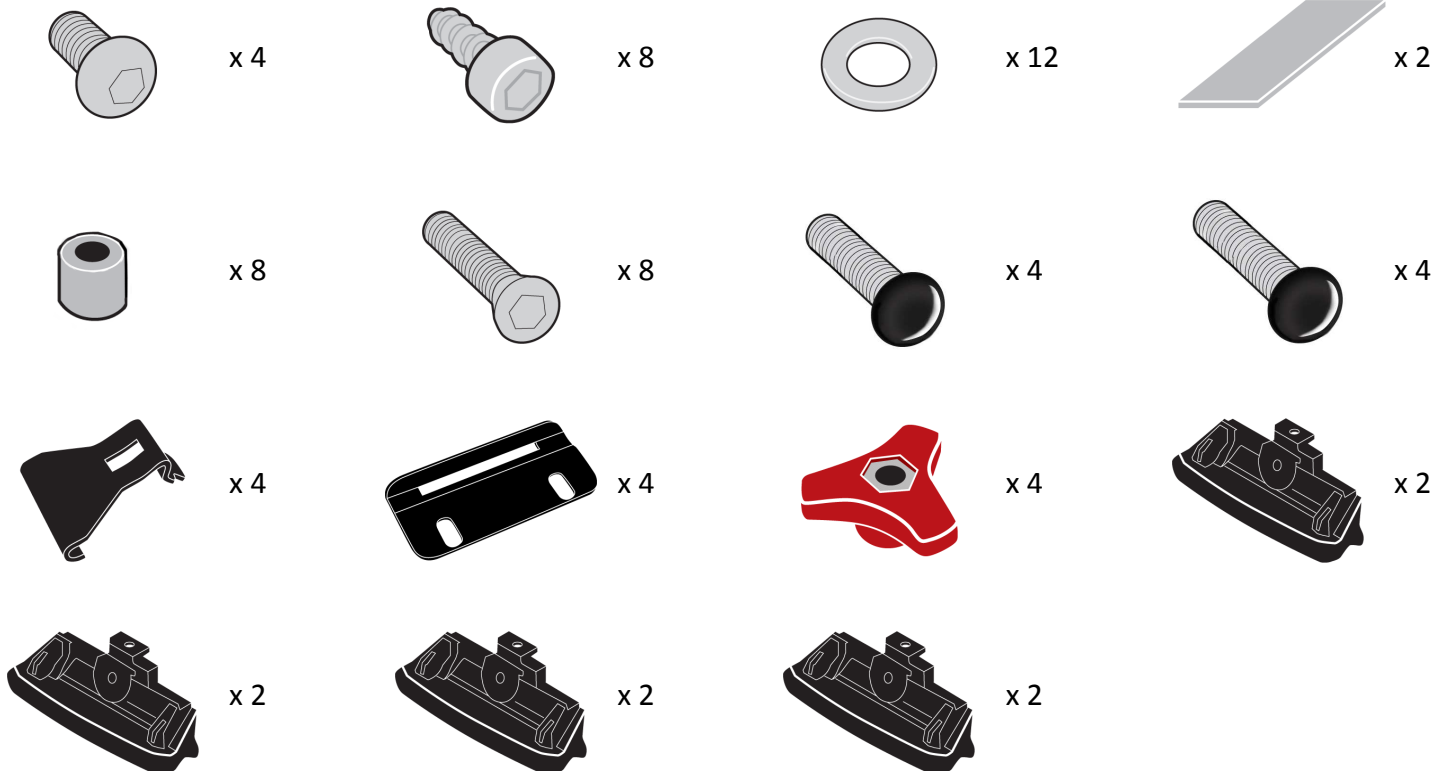

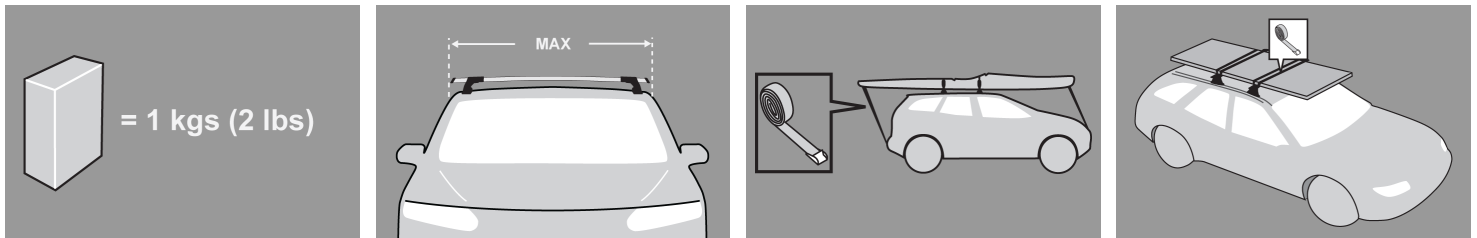

xx kg/lb

+



+



MAX

= kgs (lbs)



MAX kgs (lbs)



W/P

WHD

Nissan

X-Trail , 5dr SUV 01- 06	US	75 kgs (165 lbs)	75 kgs (165 lbs)
X-Trail , 5dr SUV 01- 06	EU	75 kgs (165 lbs)	75 kgs (165 lbs)
X-Trail , 5dr SUV 06-+	US	75 kgs (165 lbs)	75 kgs (165 lbs)
X-Trail , 5dr SUV 07-+	ZA	75 kgs (165 lbs)	75 kgs (165 lbs)
X-Trail , 5dr SUV 07-+	EU	75 kgs (165 lbs)	75 kgs (165 lbs)
X-Trail , 5dr SUV Oct 01-Sep 07	NZ	75 kgs (165 lbs)	75 kgs (165 lbs)
X-Trail , 5dr SUV Oct 01-Sep 07	AU	75 kgs (165 lbs)	75 kgs (165 lbs)
X-Trail , 5dr SUV Oct 07-+	NZ	75 kgs (165 lbs)	75 kgs (165 lbs)
X-Trail , 5dr SUV Oct 07-+	AU	75 kgs (165 lbs)	75 kgs (165 lbs)
X-Trail Lowline, 5dr SUV 01- 07	ZA	75 kgs (165 lbs)	75 kgs (165 lbs)

## First Time Installation



- Remove parts from inside the package and check. Contact your dealer if any parts are missing or damaged.

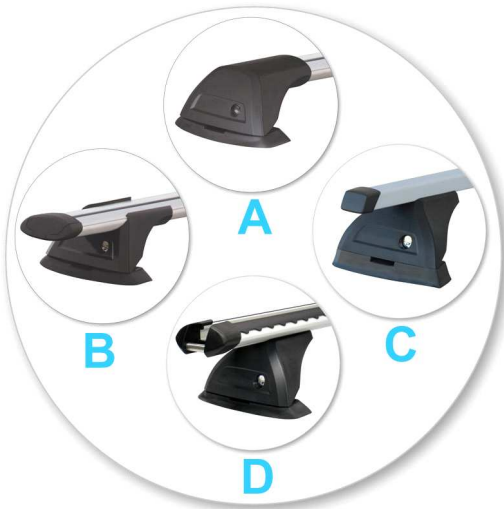

- This kit fits type A, B, C and D.
- These instructions show type A crossbar fitted. They also apply to type B, C and D.



- Use keys to remove covers.



- Use hex screwdriver to reverse adjusting screw 10 turns.



- Press adjusting screw and pull crossbar legs out. Refer to the crossbar instructions for crossbar adjustment.
- Ensure each end of the crossbar is adjusted equally.

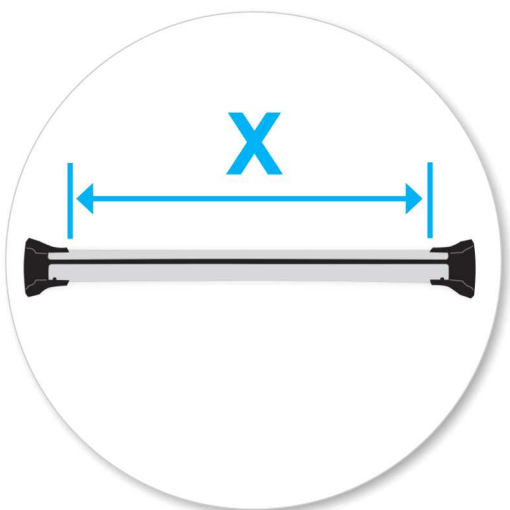

- Clamps onto flush roof rail. Pins locate on inside of rail.
- Please check the rear of this manual for information relating specifically to your vehicle.
- Set bars to length (refer to the crossbar instructions for crossbar adjustment).



- Tighten adjusting screw to 5 Nm (3.7 ft lb).

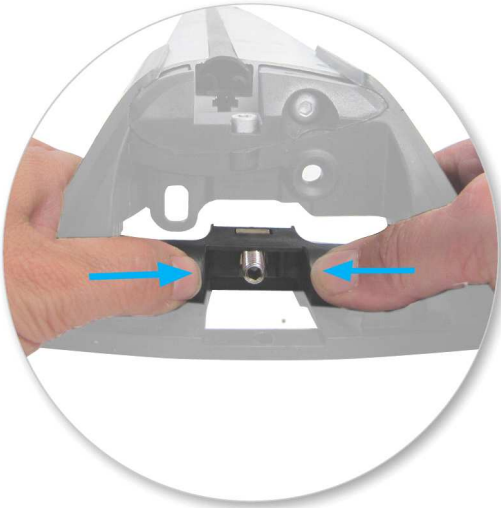

- Remove plastic clamp block by gripping bar leg with fingers and push firmly with thumbs until clamp block drops out behind leg.



- Remove both pins from each leg. Use tapered end of spanner located inside left hand cover to assist.



- Detach foot from leg. Store loose parts in a safe place.
- Repeat for all legs.



- Foot Part Number:  
X-Trail 2007 +  
= 11-02-236A left  
= 11-02-237A right  
  
X-Trail 2001-2007  
= 11-02-238A left  
= 11-02-239A right
- Select four feet assemblies and match the left and right assemblies to the left and right roof rack legs.



- Using short cap screw and washer, secure assembly onto leg (use Hex Screwdriver supplied with crossbar to assist)
- Do not over tighten.
- Repeat for all legs.



- Use two M5 x 12 mm self tapping screws to secure the assembly onto the leg.
- Do not over tighten.



- Open or remove fixed-point covers.

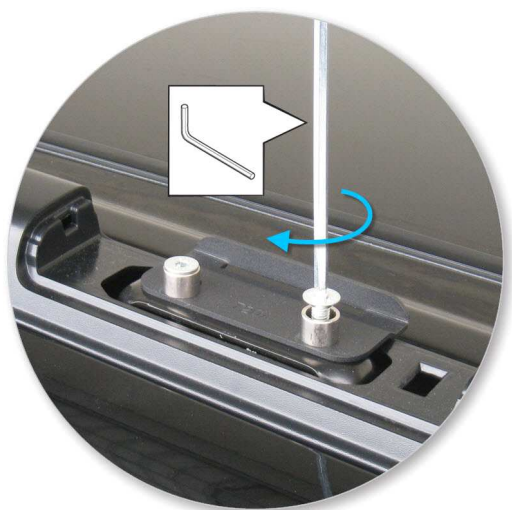

- From the kit select the mounting plates and fit the M6 x 25mm countersunk bolts through the spacer and tighten.





- Ensure edge of rail aligns with edge of slot.



- Apply protective strip as shown.  
Trim if required.

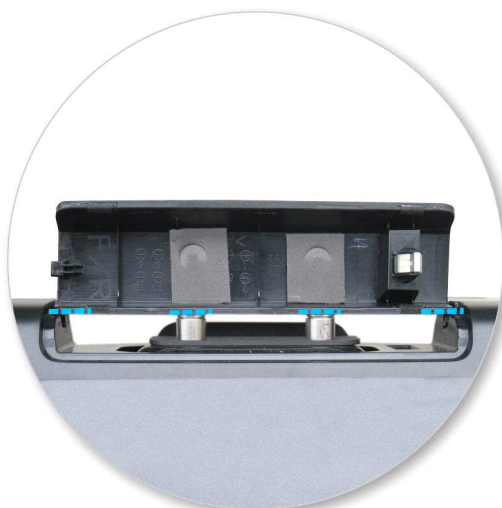

- Use fixed-point cover to check spacer height  
as shown.



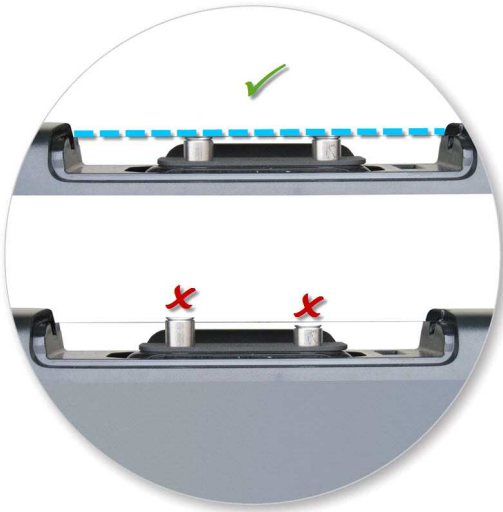

- Place washer at base of spacer to adjust height if required.



- Refit fixed-point cover.
- Repeat for all four positions.
- Fixed-point cover may require trimming to accommodate load plate.

## Fitment



- Place crossbar on vehicle.
- Ensure back edge of foot sits flush with the back edge of vehicle roof rail.



- Place one hand on the leg and apply downward pressure.
- Ensure the clamp engages correctly on inside of roof rail.



- Slide clamp through opening in leg.



- Coach bolt length:  
X-Trail 2007 + = 35 mm (1 3/8")  
X-Trail 2001-2007 = 30 mm (1 1/8")
- Thread the coach bolt through the clamp and the leg.



- Tighten the red plastic knob.
- Do not over tighten.



- Ensure the red plastic knob is in the position shown when fully tightened.
- Repeat for all four positions.



- Use keys to fit and lock covers
- Check crossbar is securely attached to the vehicle.

**CAUTION:**

**Recheck all fasteners immediately after a load is applied to the crossbars.**

**Regularly check screws are tight.**

---

## Maintenance

- Clean the car roof and surfaces of the product that will be in contact with the car roof.
- Follow the fitting instructions for fitting the product to your vehicle. Make sure all steps are carried out in order.
- Set crossbars a minimum distance of 700mm (27 1/2") apart where no other distance is specified in the fitting instructions. This is especially important when carrying long loads.
- Check unit is securely attached whenever you refit it to the vehicle. If the unit feels loose, refer to the fitting instructions and readjust.
- Some glass/panoramic roofs and radio antennae may not be able to be used when the product is fitted.
- Do not modify this product.
- Refer to the maximum permitted load capacity specified in the fitting instructions. Do not exceed the vehicle manufacturers roof load rating if it is lower than the maximum load capacity specified in the fitting instructions.
- Loads should not overhang the sides of the product and be evenly distributed with the lowest possible centre of gravity.
- Long loads should be secured with non-elastic straps to the front and rear of the vehicle.
- Objects with pointed ends (e.g. ski poles) should be carried with the pointed ends to the rear of the vehicle.
- Remove all loose or removable objects from the load prior to loading.
- Make sure all loads are securely fastened with non-elastic straps. Check regularly during longer journeys.

- A loaded roof rack system can alter the performance of your vehicle. Be especially aware of the effects of side winds, changing of direction, and braking performance. Avoid rapid acceleration and deceleration. Drive carefully.
- Note that the total height of the vehicle increases when upright loads are carried.
- Products should be locked during transport if they have locks fitted.
- Check and replace worn out or defective parts.
- Keep the product clean and maintained.
- Never drive into a car wash with the roof rack system fitted.
- Lubricate locks and adjusting screws at regular intervals.
- Remove the products from the vehicle when not in use. Make sure all loose parts are stored safely.

- Yakima Australia Pty Ltd  
17 Hinkler Court  
Brendale QLD 4500  
AUSTRALIA

[www.whispbar.com](http://www.whispbar.com)  
[www.whispbar.com.au](http://www.whispbar.com.au)  
[www.whispbar.co.nz](http://www.whispbar.co.nz)  
[www.whispbar.co.uk](http://www.whispbar.co.uk)  
[www.whispbar.co.za](http://www.whispbar.co.za)  
[www.whispbar.eu](http://www.whispbar.eu)  
[www.whispbar.ca](http://www.whispbar.ca)

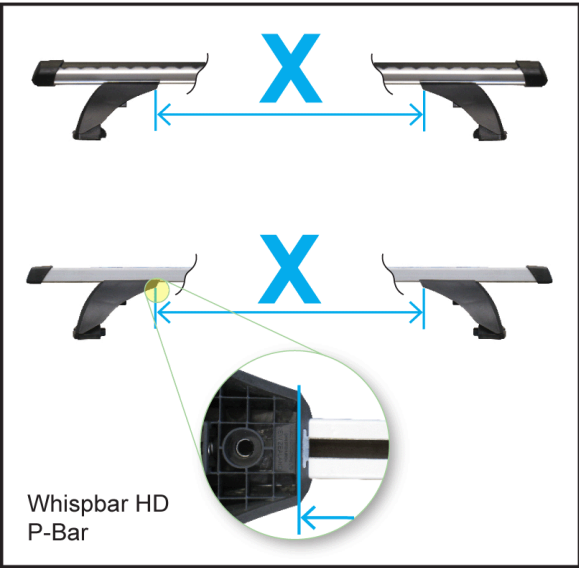
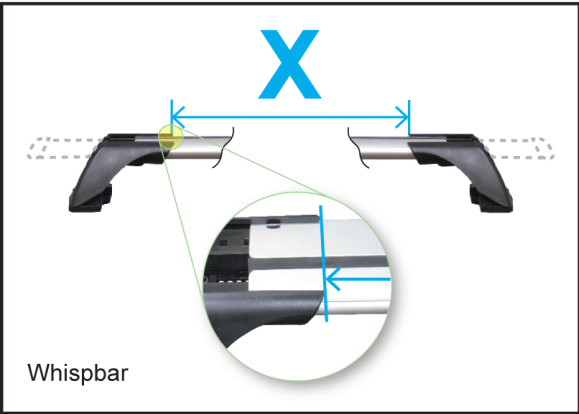
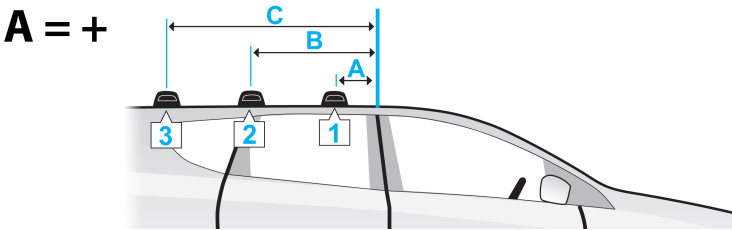
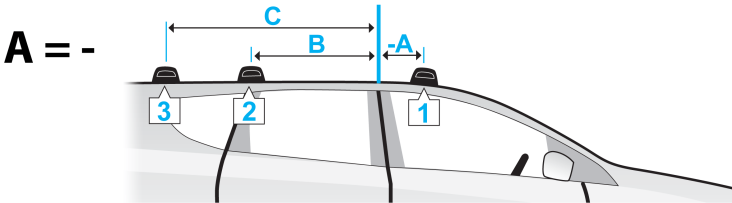

Nissan X-Trail , 5dr SUV 01- 06 (EU)
Nissan X-Trail , 5dr SUV 01- 06 (US)
Nissan X-Trail , 5dr SUV 06+ (US)
Nissan X-Trail , 5dr SUV 07+ (EU)
Nissan X-Trail , 5dr SUV 07+ (ZA)
Nissan X-Trail , 5dr SUV Oct 01-Sep 07 (AU)
Nissan X-Trail , 5dr SUV Oct 01-Sep 07 (NZ)
Nissan X-Trail , 5dr SUV Oct 07+ (AU)
Nissan X-Trail , 5dr SUV Oct 07+ (NZ)
Nissan X-Trail Lowline, 5dr SUV 01- 07 (ZA)

A	B	C	X		
			1	2	3
-140mm	590mm	-	875mm	840mm	-
-5 1/2"	23 1/4"	-	34 7/16ths"	33 1/16ths"	-
-140mm	590mm	-	875mm	840mm	-
-5 1/2"	23 1/4"	-	34 7/16ths"	33 1/16ths"	-
-30mm	720mm	-	910mm	880mm	-
-1 3/16ths"	28 3/8"	-	35 13/16ths"	34 5/8"	-
-30mm	720mm	-	910mm	880mm	-
-1 3/16ths"	28 3/8"	-	35 13/16ths"	34 5/8"	-
-30mm	720mm	-	910mm	880mm	-
-1 3/16ths"	28 3/8"	-	35 13/16ths"	34 5/8"	-
-140mm	590mm	-	875mm	840mm	-
-5 1/2"	23 1/4"	-	34 7/16ths"	33 1/16ths"	-
-140mm	590mm	-	875mm	840mm	-
-5 1/2"	23 1/4"	-	34 7/16ths"	33 1/16ths"	-
-30mm	720mm	-	910mm	880mm	-
-1 3/16ths"	28 3/8"	-	35 13/16ths"	34 5/8"	-
-30mm	720mm	-	910mm	880mm	-
-1 3/16ths"	28 3/8"	-	35 13/16ths"	34 5/8"	-
-140mm	590mm	-	875mm	840mm	-
-5 1/2"	23 1/4"	-	34 7/16ths"	33 1/16ths"	-