

**GB** Fitting Instruction for Accessory

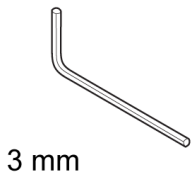

x 1

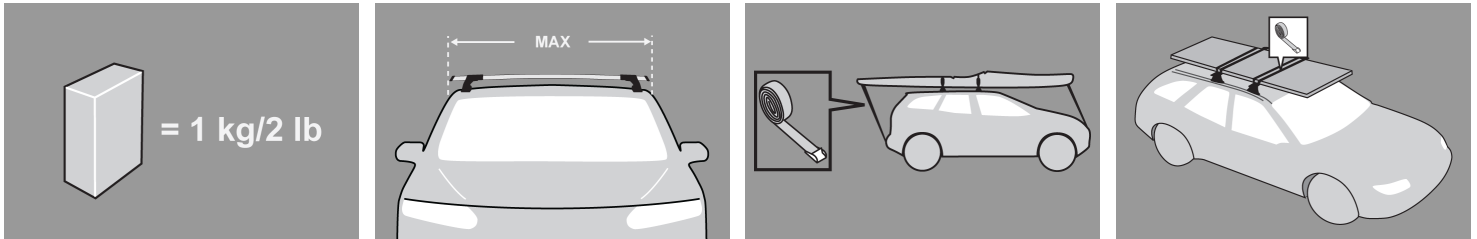
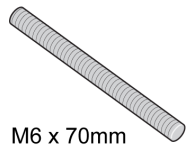

x 4

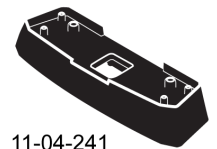
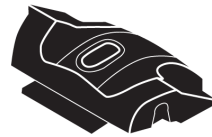

x 4

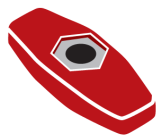

x 4



## MAX kgs

🚩 **W/P WHD**

### Land Rover

Discovery 3, 5dr SUV 04-05	ZA	75	100
Discovery 3, 5dr SUV 04-09	NZ	75	100
Discovery 4, 5dr SUV 09-+	ZA	75	100
Discovery 4, 5dr SUV 09-+	NZ	75	100
LR3, 5dr SUV 04-09	US	75	100
Range Rover Sport, 5dr SUV 04-+	ZA	75	75
Range Rover Sport, 5dr SUV 05-+	NZ	75	75
Range Rover Sport, 5dr SUV 06-+	US	75	75

## MAX kgs

🚩 **W/P WHD**

Discovery 3, 5dr SUV 04-09	EU	75	100
Discovery 3, 5dr SUV 04-09	AU	75	100
Discovery 4, 5dr SUV 09-+	EU	75	100
Discovery 4, 5dr SUV 09-+	AU	75	100
LR4, 5dr SUV 09-+	US	75	100
Range Rover Sport, 5dr SUV 04-+	EU	75	75
Range Rover Sport, 5dr SUV 05-+	AU	75	75

## First Time Installation



- Remove parts from inside the package and check. Contact your dealer if any parts are missing or damaged.

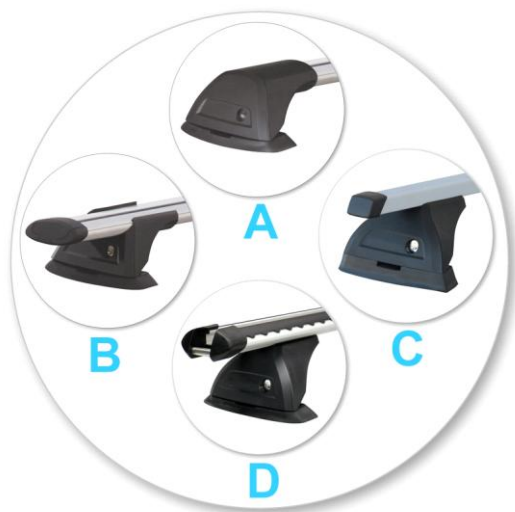

- This kit fits type A, B, C and D.
- These instructions show type A crossbar fitted. They also apply to type B, C and D.



- Use keys to remove covers.



- Use hex screwdriver to reverse adjusting screw 10 turns.



- Press adjusting screw and pull crossbar legs out. Refer to the crossbar instructions for crossbar adjustment.
- Ensure each end of the crossbar is adjusted equally.

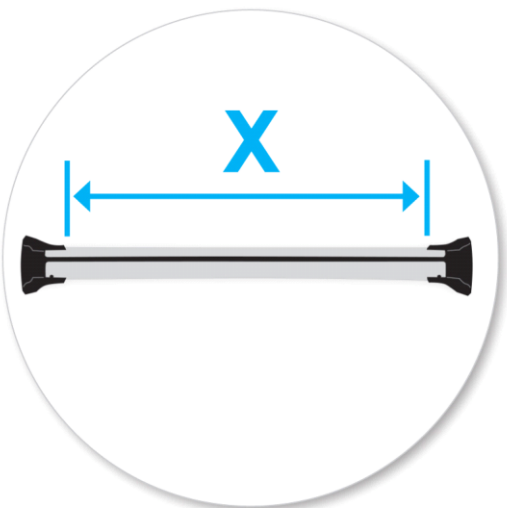

- Adjust crossbar in or out to suit vehicle. Refer to the crossbar instructions for crossbar adjustment.
- Please check the rear of this manual for information relating specifically to your vehicle.



- Tighten adjusting screw to 5 Nm (3.7 ft lb).



- Remove plastic clamp block by gripping bar leg with fingers and push firmly with thumbs until clamp block drops out behind leg.



- Select plastic internal block (from fitting kit) and insert into foot.
- Repeat for all legs.



- Fit rubber pads (supplied with fitting kit) to foot. Pad may vary in shape to that shown.
- Make sure the pad fits into the holes underneath the foot.
- Repeat for all legs.

## Fitment



- NOTE: Land Rover Discovery - Do not use front fixpoint
- Locate and remove the small plastic bungs on the roof.
- Store items away in a safe place.

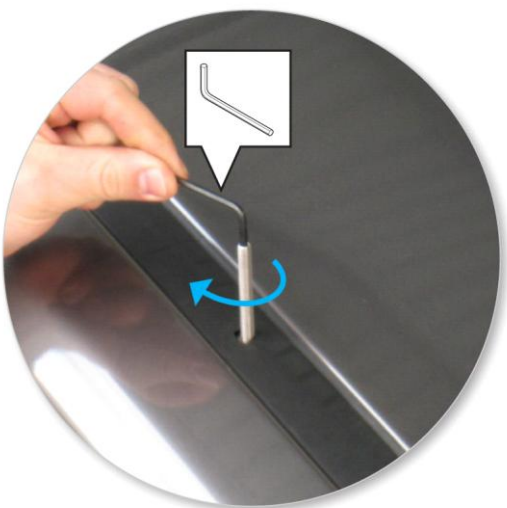

- Select grub screws and screw into the vehicle's fixed points.
- Do not over tighten.
- Repeat for all four positions.



- Place crossbar foot over grub screws.



- Ensure the pads are in the correct position and the clamp threads pass through the crossbar feet.



- Tighten the red plastic knob. The side with the nut showing should be facing up.





- In the fully tightened position, the knobs should be parallel with the vehicle.
- Repeat for all four positions.



- Check crossbar is securely attached to the vehicle.
- Use keys to fit and lock covers

**CAUTION:**  
**Recheck all fasteners immediately after a load is applied to the crossbars.**  
**Regularly check screws are tight.**



## Maintenance

- Clean the car roof and surfaces of the product that will be in contact with the car roof.
- Follow the fitting instructions for fitting the product to your vehicle. Make sure all steps are carried out in order.
- Set crossbars a minimum distance of 700mm (27 1/2") apart where no other distance is specified in the fitting instructions. This is especially important when carrying long loads.
- Check unit is securely attached whenever you refit it to the vehicle. If the unit feels loose, refer to the fitting instructions and readjust.
- Some glass/panoramic roofs and radio antennae may not be able to be used when the product is fitted.
- Do not modify this product.
- Refer to the maximum permitted load capacity specified in the fitting instructions. Do not exceed the vehicle manufacturers roof load rating if it is lower than the maximum load capacity specified in the fitting instructions.
- Loads should not overhang the sides of the product and be evenly distributed with the lowest possible centre of gravity.
- Long loads should be secured with non-elastic straps to the front and rear of the vehicle.
- Objects with pointed ends (e.g. ski poles) should be carried with the pointed ends to the rear of the vehicle.
- Remove all loose or removable objects from the load prior to loading.
- Make sure all loads are securely fastened with non-elastic straps. Check regularly during longer journeys.

- A loaded roof rack system can alter the performance of your vehicle. Be especially aware of the effects of side winds, changing of direction, and braking performance. Avoid rapid acceleration and deceleration. Drive carefully.
- Note that the total height of the vehicle increases when upright loads are carried.
- Products should be locked during transport if they have locks fitted.
- Check and replace worn out or defective parts.
- Keep the product clean and maintained.
- Never drive into a car wash with the roof rack system fitted.
- Lubricate locks and adjusting screws at regular intervals.
- Remove the products from the vehicle when not in use. Make sure all loose parts are stored safely.

- 
- Hubco Automotive Ltd  
P. O. Box 11017  
Christchurch  
NEW ZEALAND

[www.whispbar.com](http://www.whispbar.com)  
[www.whispbar.com.au](http://www.whispbar.com.au)  
[www.whispbar.co.nz](http://www.whispbar.co.nz)  
[www.whispbar.co.uk](http://www.whispbar.co.uk)  
[www.whispbar.co.za](http://www.whispbar.co.za)  
[www.whispbar.eu](http://www.whispbar.eu)  
[www.whispbar.ca](http://www.whispbar.ca)

---

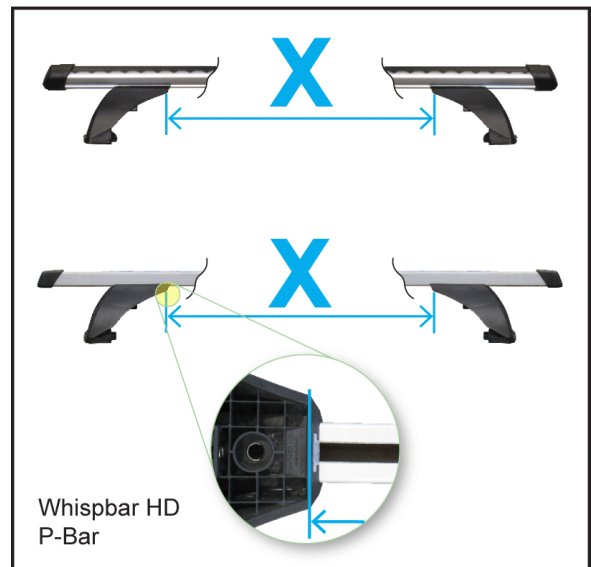
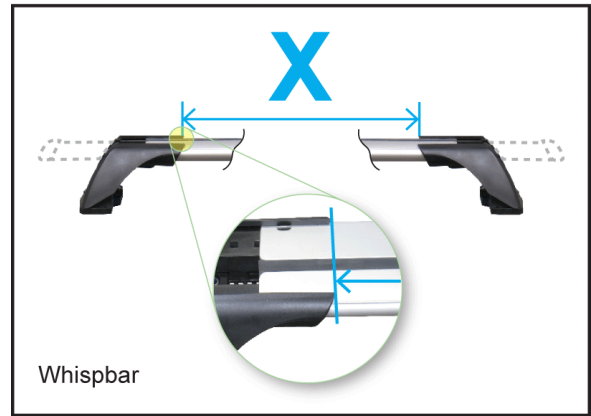
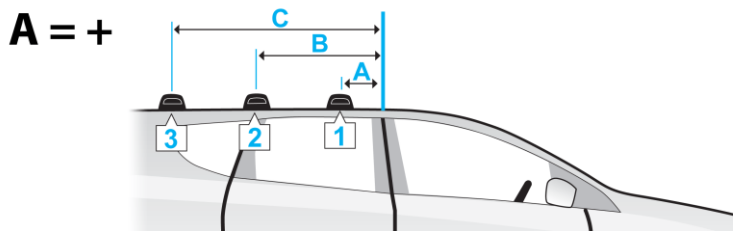
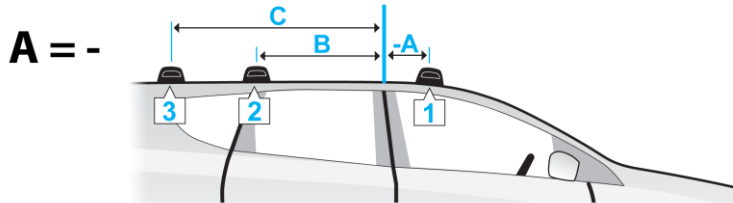

	A	B	C	X		
				1	2	3
Land Rover Discovery 3, 5dr SUV 04- 05 (ZA)	-330mm -13 "	250mm 9 13/16ths"	840mm 33 1/16ths"	-	950mm 37 3/8"	935mm 36 13/16ths"
Land Rover Discovery 3, 5dr SUV 04- 09 (AU)	-330mm -13 "	250mm 9 13/16ths"	840mm 33 1/16ths"	-	950mm 37 3/8"	935mm 36 13/16ths"
Land Rover Discovery 3, 5dr SUV 04- 09 (EU)	-330mm -13 "	250mm 9 13/16ths"	840mm 33 1/16ths"	-	950mm 37 3/8"	935mm 36 13/16ths"
Land Rover Discovery 3, 5dr SUV 04- 09 (NZ)	-330mm -13 "	250mm 9 13/16ths"	840mm 33 1/16ths"	-	950mm 37 3/8"	935mm 36 13/16ths"
Land Rover Discovery 4, 5dr SUV 09-+ (AU)	-330mm -13 "	250mm 9 13/16ths"	840mm 33 1/16ths"	-	950mm 37 3/8"	935mm 36 13/16ths"
Land Rover Discovery 4, 5dr SUV 09-+ (EU)	-330mm -13 "	250mm 9 13/16ths"	840mm 33 1/16ths"	-	950mm 37 3/8"	935mm 36 13/16ths"
Land Rover Discovery 4, 5dr SUV 09-+ (NZ)	-330mm -13 "	250mm 9 13/16ths"	840mm 33 1/16ths"	-	950mm 37 3/8"	935mm 36 13/16ths"
Land Rover Discovery 4, 5dr SUV 09-+ (ZA)	-330mm -13 "	250mm 9 13/16ths"	840mm 33 1/16ths"	-	950mm 37 3/8"	935mm 36 13/16ths"
Land Rover LR3 , 5dr SUV 04- 09 (US)	-330mm -13 "	250mm 9 13/16ths"	840mm 33 1/16ths"	-	950mm 37 3/8"	935mm 36 13/16ths"
Land Rover LR4 , 5dr SUV 09-+ (US)	-330mm -13 "	250mm 9 13/16ths"	840mm 33 1/16ths"	-	950mm 37 3/8"	935mm 36 13/16ths"
Land Rover Range Rover Sport, 5dr SUV 04-+ (ZA)	-200mm -7 7/8"	380mm 14 15/16ths"	940mm 37 "	1040mm 40 15/16ths"	1030mm 40 9/16ths"	1015mm 39 15/16ths"
Land Rover Range Rover Sport , 5dr SUV 04-+ (EU)	-200mm -7 7/8"	380mm 14 15/16ths"	940mm 37 "	1040mm 40 15/16ths"	1030mm 40 9/16ths"	1015mm 39 15/16ths"
Land Rover Range Rover Sport , 5dr SUV 05-+ (AU)	-200mm -7 7/8"	380mm 14 15/16ths"	940mm 37 "	1040mm 40 15/16ths"	1030mm 40 9/16ths"	1015mm 39 15/16ths"
Land Rover Range Rover Sport , 5dr SUV 05-+ (NZ)	-200mm -7 7/8"	380mm 14 15/16ths"	940mm 37 "	1040mm 40 15/16ths"	1030mm 40 9/16ths"	1015mm 39 15/16ths"
Land Rover Range Rover Sport , 5dr SUV 06-+ (US)	-200mm -7 7/8"	380mm 14 15/16ths"	940mm 37 "	1040mm 40 15/16ths"	1030mm 40 9/16ths"	1015mm 39 15/16ths"

