

WHISPBAR INSTRUCTIONS

Assembly Instructions for Whispbar (S51 - S56)

Kit contains:

- 1 x Set of Assembly Instructions
- 1 x 5 mm Hex Key (located in roof rack leg)
- 2 x Crossbars (labelled front and rear)
- 2 x Keys

Remove parts from box & check
Contact your Prorack dealer if any parts are missing or damaged

Important notes:

- Any instructions in vehicle owners manual should be complied with
- Before fitting to vehicle, please identify front of crossbar as shown
- Please retain these instructions for future use
- Maximum load rating is 75 kg

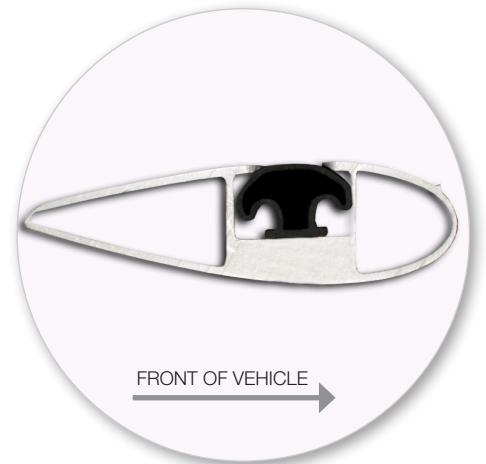

1. Crossbar Preparation



1.1



Unlocked



Locked

- Use keys to unlock covers



1.2

- While holding the head of the key down, pull the cover towards you to remove
- Repeat on all four legs



1.3

- Locate the 5 mm Hex Key in one of the roof rack legs



1.4

- Remove Hex Key by lifting and sliding out

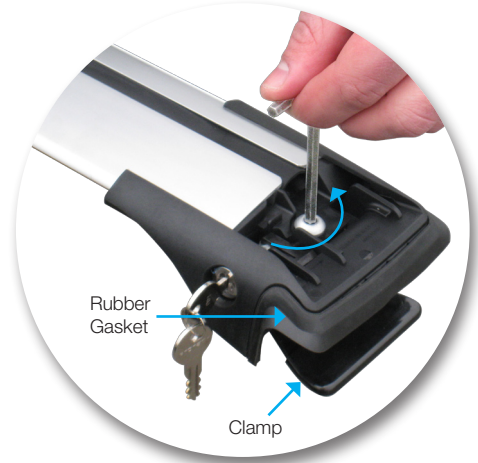

1.5

- Using Hex Key loosen screw approx. 10 turns

2. Positioning Crossbar on Roof Rails



2.1

- Position one end of front crossbar on the opposite roof rail and swing the free end so that the clamp is under the rail and the rubber gasket sits on top. Repeat for rear.
- Repeat on other crossbar
- Crossbar spacing should be 650 mm
- Crossbars should be parallel to each other
- Crossbars should be perpendicular to the centre line of the vehicle

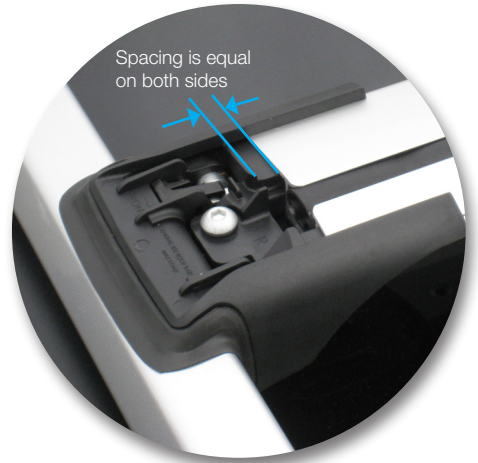

2.2

- Pull legs out evenly until both rubber gaskets seal on roof rail
- Ensure the crossbars are adjusted equally at both ends
- Note that legs can pivot slightly to accommodate roof rail taper



2.3

- Once both crossbars are in position, tighten screw (5 Nm)
- Repeat on all four legs



2.4

- Correctly fitted



2.5

- Slide Hex Key back into position into one of the roof rack legs



2.6

- Ensure the locks on the legs are in the locked position (horizontal)
- Slide cover into position
- You will hear a 'click' when the cover is in the locked position and repeat on all four legs



2.7

- Leg with locked cover



2.8

- Correctly fitted crossbars

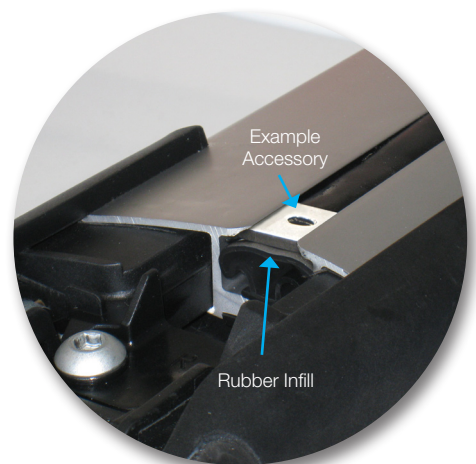

2.9

- To fit accessories, open the cover
- Do not remove rubber infill
- Apply silicon or equivalent onto the rubber infill
- Depress rubber infill and slide accessories into crossbar
- Lock accessory into position
- Once accessory is fitted refit and lock cover

WARNING: Check the Tightness of Screws Regularly

Important Instructions for Use

The rack is by design, a safe product. Unfortunately, the use, application and operation of the rack system is outside Prorack's control and must therefore be your responsibility. When fitted and used correctly and maintained adequately, this rack provides many years of dependable service.

The following list provides an effective check to ensure all loads are correctly mounted on the rack.

- Check the tightness of the screw attachments regularly, especially after travelling on rough surfaces. Also check attachments after first couple of uses when newly assembled.
- Spread the load evenly across and between the bars.
- **Maximum load rating is 75 kg.**
- Load should not overhang the sides of the roof rack.
- Ensure all loads are securely fastened. Check regularly during longer journeys.
- A loaded rack system can alter the performance of your vehicle. Be especially aware of the effects of cross-winds, changes in direction and braking performance. Avoid rapid acceleration and deceleration. Drive carefully.
- When carrying long loads, such as canoes or pipes, always use the appropriate accessory and tie the front and back of the load to the "tie-down hooks" supplied with the accessory, to avoid the load being lifted by airflow.
- If the load overhangs the rear of the vehicle, tie a flag at the rear end of the load to improve visibility for the following vehicles.
- On vans and wagons, ensure tailgate opens clear of the rear of load.
- Ensure that instructions in your vehicle owners manual are complied with in the attachment and loading of the rack. If your vehicle owners manual gives a lower permitted roof load rating than that stated in these instructions, then the lower limit is applicable. You must not exceed the load capacity of the vehicle roof.

Warranty & Disclaimer

1. Where the product is supplied to the customer for other than business purposes within the meaning of section 43 of the New Zealand Consumer Guarantees Act 1993, the provisions of that Act shall apply. It is important that anyone who fits or uses this product does so in accordance with the manufacturers instructions.
2. Where the product is supplied to the customer for business purposes within the meaning of section 43 of the New Zealand Consumer Guarantees Act 1993, the provisions of that Act and all other representations or terms (including any conditions or warranty expressed or implied by law, statute or otherwise) not expressly included in this leaflet are hereby expressly excluded shall have no effect and the clauses below shall apply. Where the product is supplied and purchased in Australia, the following shall apply:
 - a) THE SUPPLIER WARRANTS the product to be free from defects in materials and/or workmanship for a period of three (3) years from the date of original purchase (the warranty period). Proof of purchase is required. Subject to the limitations and exclusions set out below, the Supplier hereby agrees to remedy any defects in materials or workmanship becoming apparent during the warranty period, by replacing or repairing any defective product or component (at its option) free of charge to the purchaser in respect of replacement parts or labour. Any defective product or component must be notified and where practicable, returned at the purchaser's expense to the Supplier immediately upon discovery of the alleged defect and no attempt made on the part of the purchaser to repair it.
 - b) EXCEPTIONS, EXCLUSIONS AND LIMITATIONS TO WARRANTY. The product and/or its components must be fitted/assembled and loaded in accordance with the Supplier's written instructions and any requirements set out in the car's owner manual. This warranty does not cover defects, loss or damage resulting a circumstances beyond the Supplier's control including, but not limited to misuse, overloading, or failure to assemble and/or fit the product or component in accordance with the Supplier's written instructions. Nor does the warranty cover defects, loss or damage resulting from accidents, unlawful use of the vehicle or defects/inconsistencies in the vehicle on which the product or component is fitted. Liability for direct, indirect, special, punitive, incidental, exemplary, contractual or consequential damage or loss arising from defects, faulty materials or design omissions or negligence or workmanship in the product or its components is hereby expressly excluded. Certain Commonwealth legislation, including the Trade Practices Act 1974, and other State and Territorial legislation confers upon purchasers rights which cannot be excluded from or be restricted or modified by contract. Any conditions, guarantees and/or warranties implied by law and incapable of exclusion are deemed to be expressly incorporated herein. Nothing herein contained is intended nor shall be permitted to be inconsistent with any such conditions, guarantees and/or warranties. To the extent permitted by legislation all conditions, guarantees and/or warranties such as implied warranties which are capable of exclusion are hereby expressly excluded and negated.

Hubco Automotive Ltd Freephone New Zealand:
46 Parkhouse Road 0800 4776 722
PO Box 11-017 Freephone Australia:
Christchurch 8004 1800 143 548
New Zealand