

easy2go

easy2go *plus*

 RUD®



MAIN GUIDE

Betriebsanleitung · **Fitting instructions** · Mode d'emploi · **Istruzioni per il montaggio** · Gebruiksaanwijzing
Instrucciones de montaje · Instrukcja użytkowania · **Οδηγίες χρήσης** · Instructiuni de utilizare

easy**2**go



easy**2**go *plus*

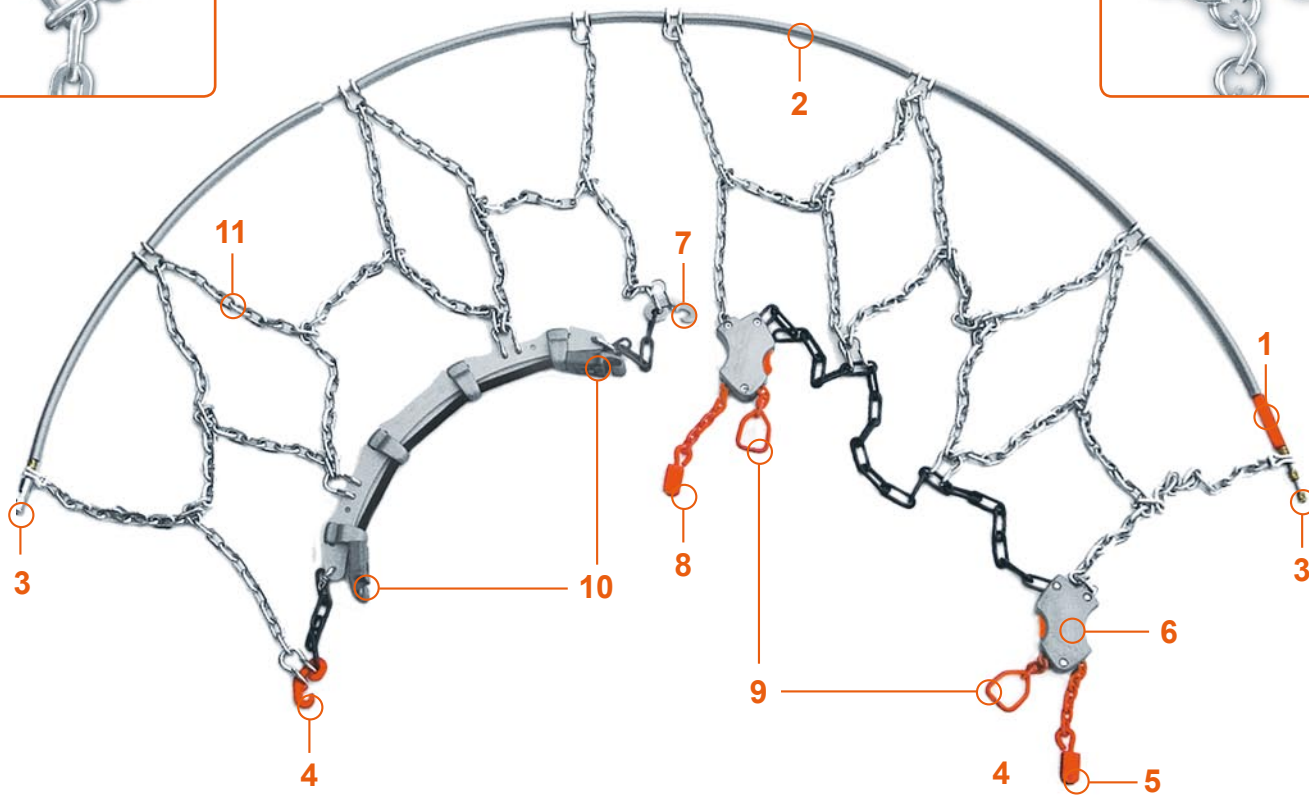



FITTING



A neatly laid out chain makes fitting easier.

Leading with the orange-coloured ring end (1), pull your chain round behind the wheel.

The ring (2) should then lie near the back of the tyre.



Take both ends of the ring and pull them up around the tyre tread.



All the illustrations in this guide show the RUD **easy2go**. However, all the fitting steps and instructions also apply to the **easy2go plus** model.



All the steps are clearly summarized again in the practical **Quick Guide**. Its plastic foil also provides something to kneel on while fitting the chains.



Do you own a four-wheel drive vehicle? Its instruction manual will state on which axle (front or back) the snow chains should be fitted.



Now hook the connecting pieces (3) together.

The close-up view on the right shows how the wire hoop looks when connected.



Now, on the upper part of the wheel, hook the orange hook (4) into the eyelet (5). This is easier if you pull the orange chain a little out of the ratchet (6). To do this, press the orange knob.

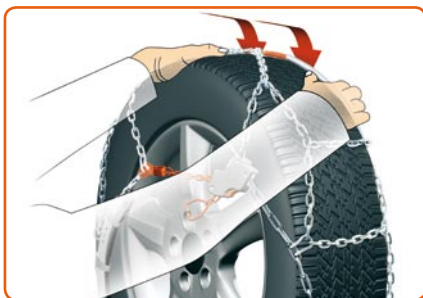

Slide the wire hoop over the tread until it lies on the back of the tyre. The back view on the right shows the wire hoop lying correctly on the inner sidewall of the tyre, which cannot be seen from the front.





Now, on the lower part of the wheel, hook the grey hook (7) into the eyelet (8). Once again, this is easier if you pull the orange chain a little out of the ratchet. To do this, press the knob.



Now you just have to hook the two eyelets (9) into the plastic hook of the rubber tensioner (10).



Please ensure that the chain mesh is lying evenly spread over the outer sidewall of the tyre. Your **easy2go** automatically re-tightens during your journey.

Have a pleasant journey!

REMOVAL

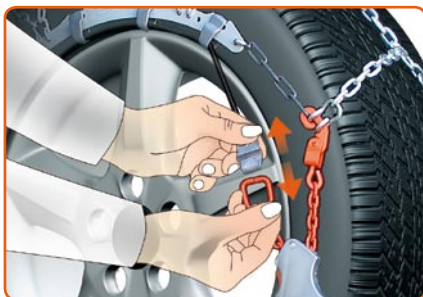

To remove the snow chains, park your vehicle so that the wheel comes to a halt with the orange hook (4) in the position shown in the diagram on the right. Then unhook the two eyelets (9) from the rubber tensioner (10).

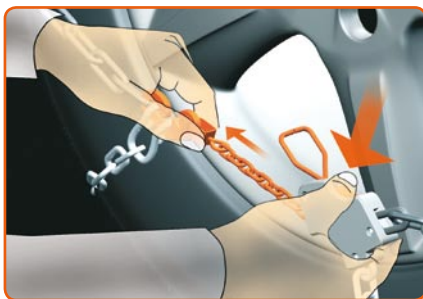

Now release the tensioning chain. To do this, press the release button on the ratchet (6) and pull the chain back. Repeat this step on the second ratchet.



On a front-wheel drive, the orange hook (4) should be about level with the axle. It is easier to remove the chain if you turn the hook-side of the wheel outwards.



On a rear-wheel drive, the orange hook (4) should be at the top.



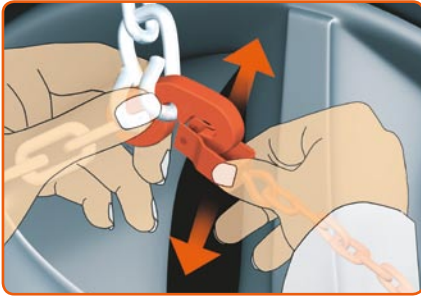

Unhook the orange (4) and grey (7) hooks.



Grasp the chain mesh (11) near the orange hook and by the tensioning device. Pull it to the centre of the wheel. This brings the connector (3) to the front. Open the connector.



If the chain does not move outwards, shake it to loosen, and make removal easier.



You can now lay the snow chain on the ground, and remove your second chain from the other side of the vehicle.

Then drive away from the chains.

NOTES



Please ensure that your snow chains are the right size for the tyres fitted to your vehicle. The type-size designation on the tyres must be identical with the size stated on the chain packaging. For example, there is a big difference between 195/65-15 and 195-15.



There is a risk of the chain breaking when the links of the chain mesh have worn below 50 percent. Do not use chains which are more than 50% worn – replace them.



Do not drive at more than 50 kph (30 mph) with snow chains. This is the maximum speed permitted under the traffic regulations in Germany and other countries.



Your **easy2go**, like all RUD snow chains, fulfils the Austrian standard, and so it is also approved for use in Austria.



Snow chains must not be oiled. Therefore, wash your chain in warm water after use and allow to dry.



RUD provides a repair and modification service. If necessary, return the chain to RUD Ketten. You will find the address on the back of your fitting guide.



We always accept our packaging back via our sales network.

D
Deutsch

GB
English

F
Français

I
Italiano

NL
Nederlands

E
Español

PL
Polski

GR
Ελληνικά

RO
Român



RUD Ketten • Rieger & Dietz GmbH u. Co. KG
Friedensinsel • 73432 Aalen • Germany
Tel.: +49 7361-504-0 • Fax: +49 7361-504-1802
GL@rud.com • www.rud.com