

# Kit 1049

- MITSUBISHI Galant**, 4-dr Sedan, 97-05
- MITSUBISHI Emeraude**, 4-dr Sedan, \*96-05
- MITSUBISHI Eterna**, 4-dr Sedan, \*96-05
- PROTON Perdana**, 4-dr Sedan, 95-10
- PROTON Wira**, 5-dr Hatchback, 93-07
- PROTON Wira**, 4-dr Sedan, 93-07

\*Asia

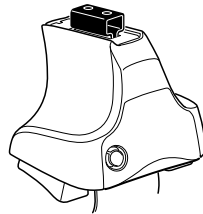

**754** Rapid System  
**480R** Rapid Traverse (North America)

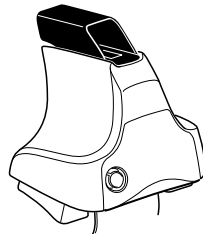
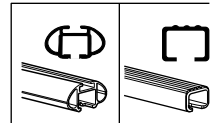

**480** Traverse (North America)

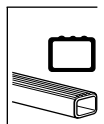

754 Rapid System  
480R Rapid Traverse (North America)

480 Traverse (North America)

1

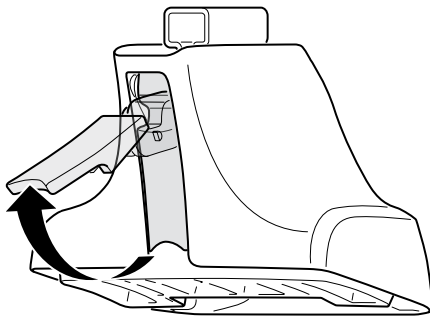

2



754 Rapid System  
480R Rapid Traverse  
(North America)

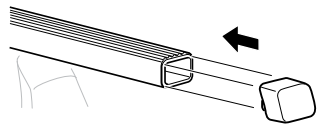
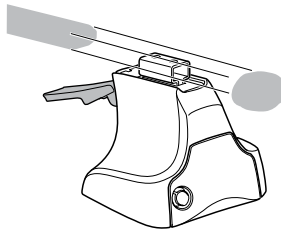

x4

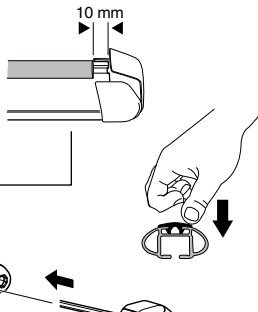
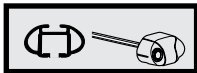

x4

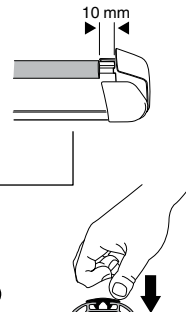
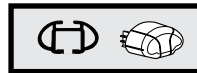

x4



480 Traverse  
(North America)

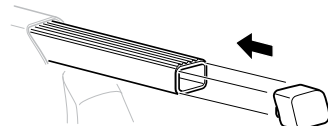
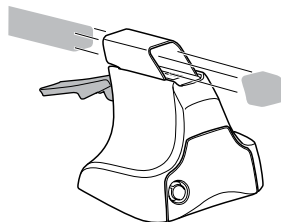

x4

**3**

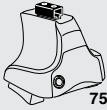

**754** Rapid System

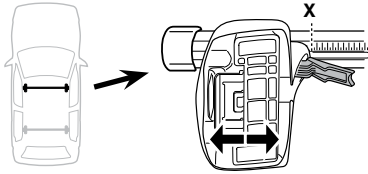

	X
<b>MITSUBISHI Galant</b> , 4-dr Sedan, 97-05	<b>32,5</b>
<b>MITSUBISHI Emeraude</b> , 4-dr Sedan, *96-05	<b>32,5</b>
<b>MITSUBISHI Eterna</b> , 4-dr Sedan, *96-05	<b>32,5</b>
<b>PROTON Perdana</b> , 4-dr Sedan, 95-10	<b>32,5</b>
<b>PROTON Wira</b> , 5-dr Hatchback, 93-07	<b>27</b>
<b>PROTON Wira</b> , 4-dr Sedan, 93-07	<b>27</b>

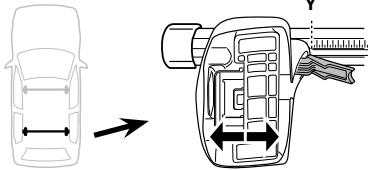

	Y
<b>MITSUBISHI Galant</b> , 4-dr Sedan, 97-05	<b>31,5</b>
<b>MITSUBISHI Emeraude</b> , 4-dr Sedan, *96-05	<b>31,5</b>
<b>MITSUBISHI Eterna</b> , 4-dr Sedan, *96-05	<b>31,5</b>
<b>PROTON Perdana</b> , 4-dr Sedan, 95-10	<b>31,5</b>
<b>PROTON Wira</b> , 5-dr Hatchback, 93-07	<b>26,5</b>
<b>PROTON Wira</b> , 4-dr Sedan, 93-07	<b>26,5</b>

**3**



**480R** Rapid Traverse



**480** Traverse



**(North America)**

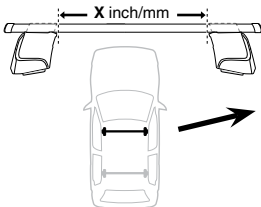

	X inch	X mm
<b>MITSUBISHI Galant</b> , 4-dr Sedan, 97-05	<b>38 <sup>3</sup>/<sub>8</sub> "</b>	<b>976 mm</b>
<b>MITSUBISHI Emeraude</b> , 4-dr Sedan, *96-05	<b>38 <sup>3</sup>/<sub>8</sub> "</b>	<b>976 mm</b>
<b>MITSUBISHI Eterna</b> , 4-dr Sedan, *96-05	<b>38 <sup>3</sup>/<sub>8</sub> "</b>	<b>976 mm</b>
<b>PROTON Perdana</b> , 4-dr Sedan, 95-10	<b>38 <sup>3</sup>/<sub>8</sub> "</b>	<b>976 mm</b>
<b>PROTON Wira</b> , 5-dr Hatchback, 93-07	<b>36 <sup>1</sup>/<sub>8</sub> "</b>	<b>916 mm</b>
<b>PROTON Wira</b> , 4-dr Sedan, 93-07	<b>36 <sup>1</sup>/<sub>8</sub> "</b>	<b>916 mm</b>

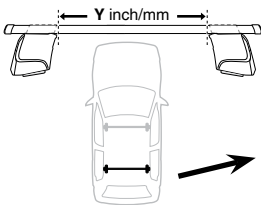

	Y inch	Y mm
<b>MITSUBISHI Galant</b> , 4-dr Sedan, 97-05	<b>38 "</b>	<b>966 mm</b>
<b>MITSUBISHI Emeraude</b> , 4-dr Sedan, *96-05	<b>38 "</b>	<b>966 mm</b>
<b>MITSUBISHI Eterna</b> , 4-dr Sedan, *96-05	<b>38 "</b>	<b>966 mm</b>
<b>PROTON Perdana</b> , 4-dr Sedan, 95-10	<b>38 "</b>	<b>966 mm</b>
<b>PROTON Wira</b> , 5-dr Hatchback, 93-07	<b>36 <sup>1</sup>/<sub>8</sub> "</b>	<b>916 mm</b>
<b>PROTON Wira</b> , 4-dr Sedan, 93-07	<b>36 <sup>1</sup>/<sub>8</sub> "</b>	<b>916 mm</b>

**4**

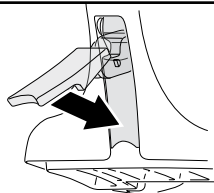

**5**

**MITSUBISHI Galant**, 4-dr Sedan, 97-05  
**MITSUBISHI Emeraude**, 4-dr Sedan, \*96-05  
**MITSUBISHI Eterna**, 4-dr Sedan, \*96-05  
**PROTON Perdana**, 4-dr Sedan, 95-10  
**PROTON Wira**, 5-dr Hatchback, 93-07  
**PROTON Wira**, 4-dr Sedan, 93-07

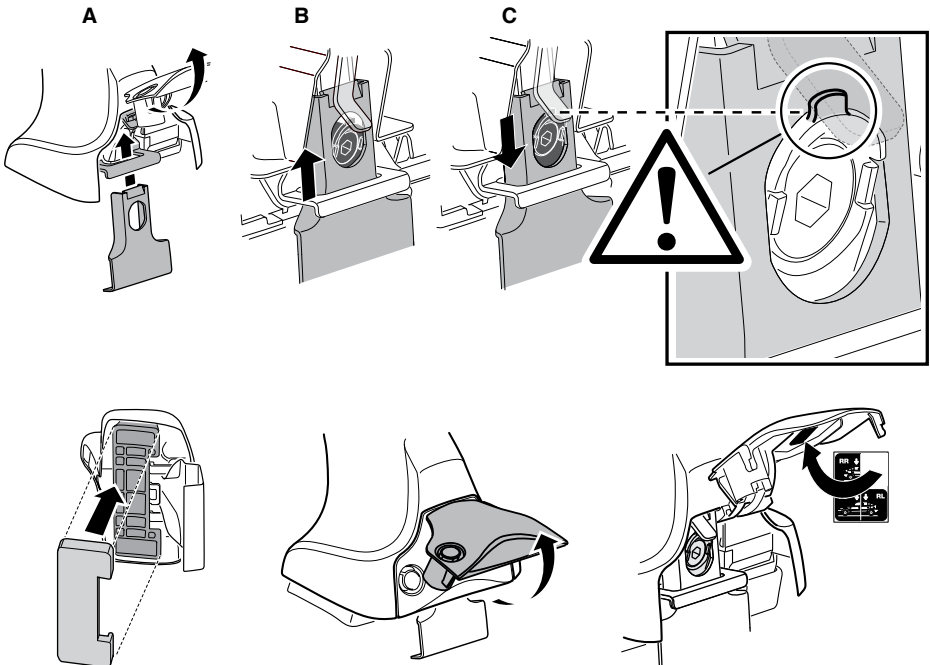
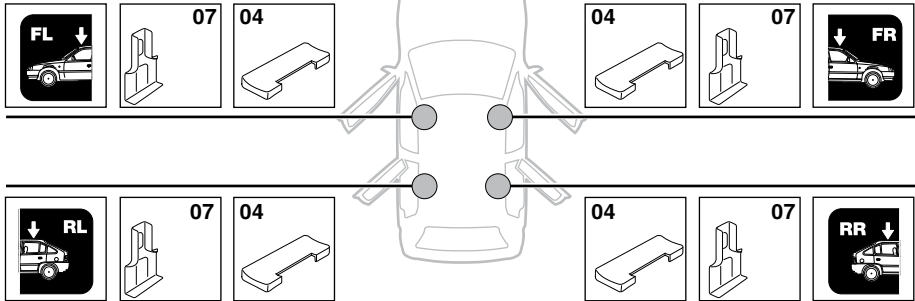

6

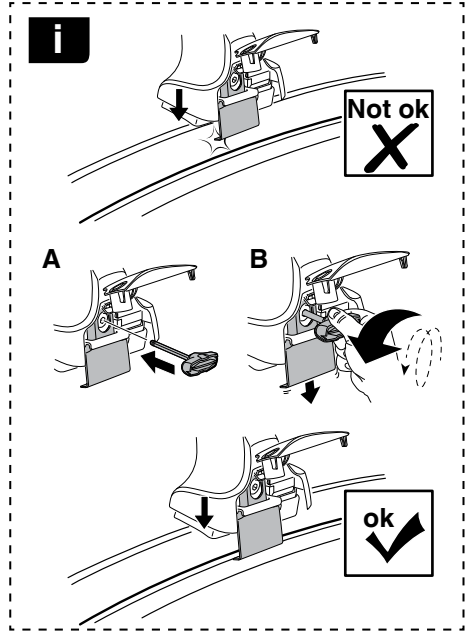
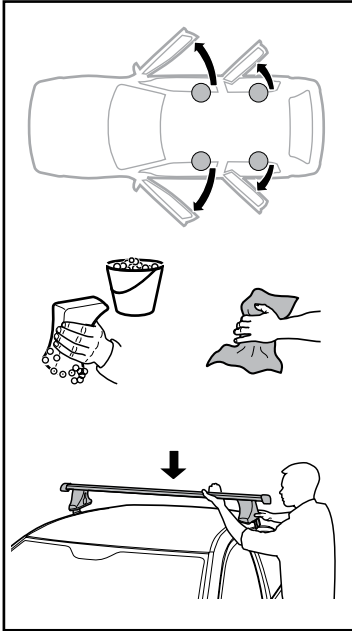

	X mm	Y mm	X inch	Y inch
<b>MITSUBISHI Galant, 4-dr Sedan, 97-05</b>	180 mm	650 mm	7 1/8"	25 5/8"
<b>MITSUBISHI Emeraude, 4-dr Sedan, *96-05</b>	180 mm	650 mm	7 1/8"	25 5/8"
<b>MITSUBISHI Eterna, 4-dr Sedan, *96-05</b>	180 mm	650 mm	7 1/8"	25 5/8"
<b>PROTON Perdana, 4-dr Sedan, 95-10</b>	180 mm	650 mm	7 1/8"	25 5/8"
<b>PROTON Wira, 5-dr Hatchback, 93-07</b>	200 mm	600 mm	7 7/8"	23 5/8"
<b>PROTON Wira, 4-dr Sedan, 93-07</b>	200 mm	600 mm	7 7/8"	23 5/8"

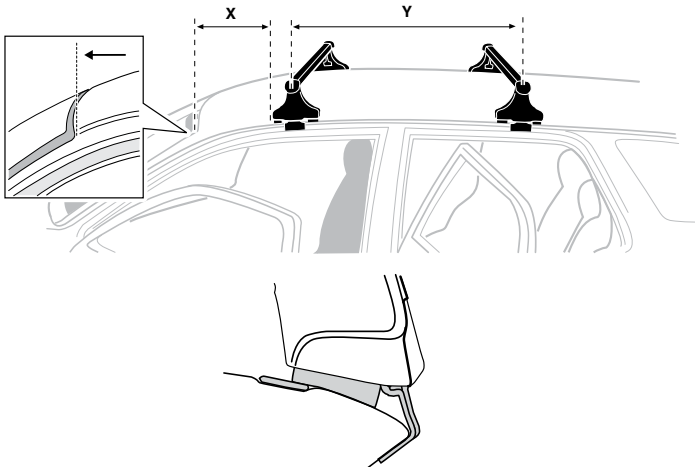

7

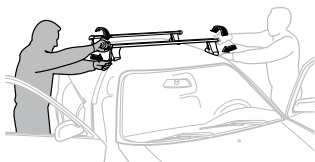

GB/US	Tighten alternately
D	Die Schrauben abwechselnd anziehen
F	Serrer alternativement chaque côté
NL	Afwisselend aan de linker- en de rechterkant aandraaien
I	Alternare il serraggio delle viti
E	Apertar alternativamente
PT	Aperte alternadamente
S	Dra åt växelvis
FIN	Kierrä vuorotellen
EST	Pinguldage vaheldumisi
LAT	Pielveiciet pamišus
LIT	Užsukinėkite pakaitomis
PL	Śruby dokręcaj naprzemiennie
RU	Загтягивайте попеременно

CZ	Pokręťta bagażnika dokręcaj naprzemiennie.
SK	Dofahajte striedavo
SLO	Privijajte izmenično.
HR	Naizmjenično zategnite
HU	Egymástól függetlenül szorítandó
GR	Σφιγίγτες εναλλάξ
TR	Dönüşümlü sıkın

中文 交替拧紧

한국어 번갈아 가며 조이십시오.

日本語 交互に締め付けてください。

ไทย ชันในแบบสลับ

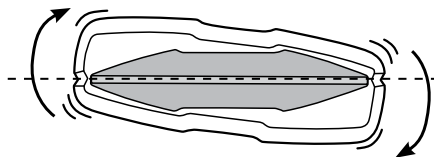
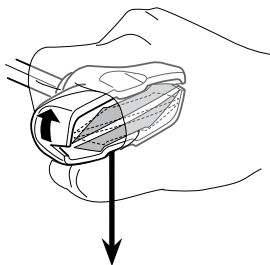
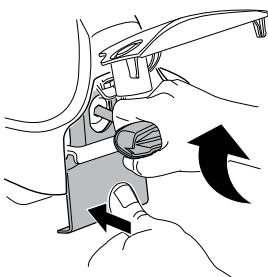
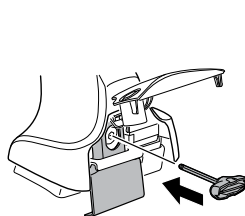

≈ 3 Nm

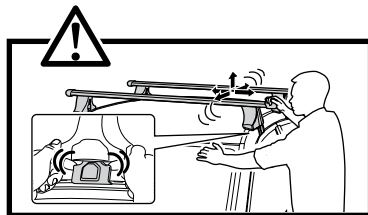
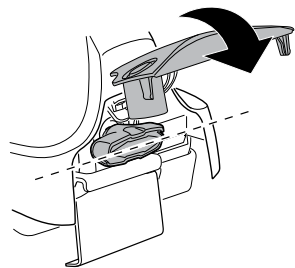

8

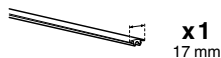



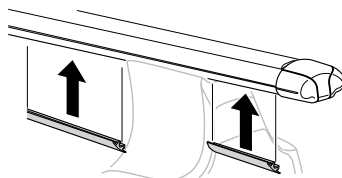
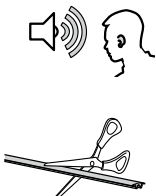

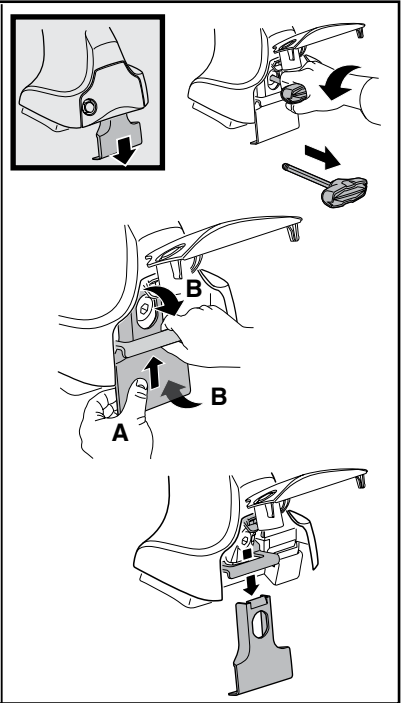
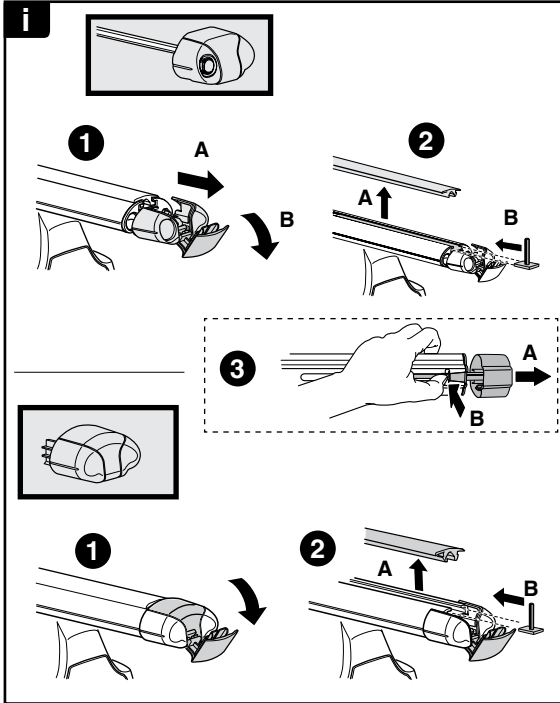
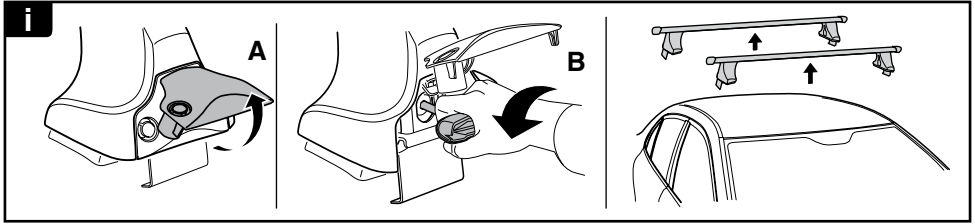
x1  
17 mm



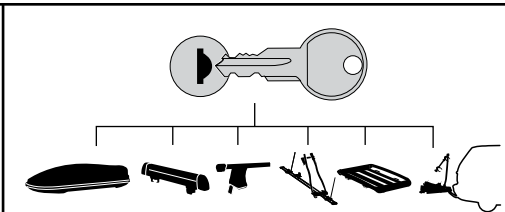

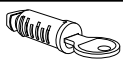
**THULE**  
SWEDEN  
**ONE  
KEY  
SYSTEM**



-  **544** (x4)
  -  **596** (x6)
  -  **588** (x8)
  -  **510** (x10)
  -  **452** (x12)
- NA  
EUR  
ASIA

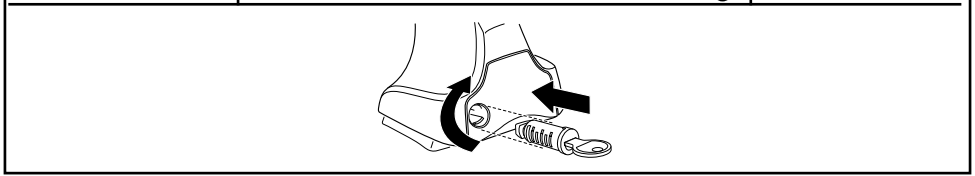

WW ▶ Thule Sweden AB, Box 69, 330 33 Hillerstorp, SWEDEN  
NA ▶ Thule Inc., 42 Silvermine Road, Seymour, Connecticut 06483, USA

info@thule.com  
customer.service@thule.com

 www.thule.com