

# Kit 1132

ALFA ROMEO 166, 4-dr Sedan, 98-03, 04-07

480R  
754

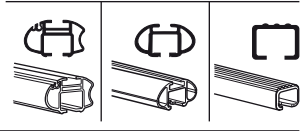
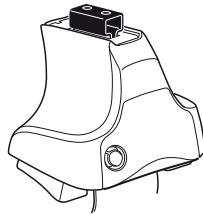

480

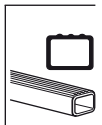
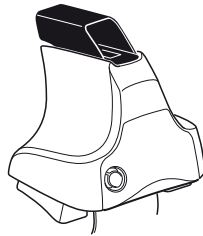

750

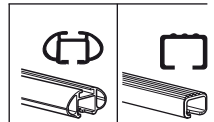
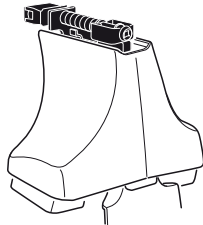

x2	x2	x2	x2	x2
x2		x2	x2	
x2		x4		
x4		x4		

**Kit**



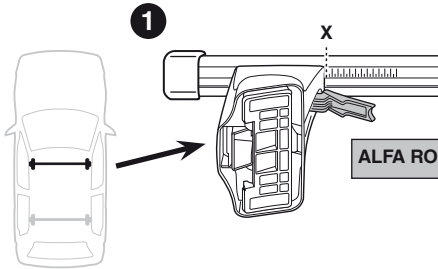

	X
ALFA ROMEO 166, 4-dr Sedan, 98-03, 04-07	30,5

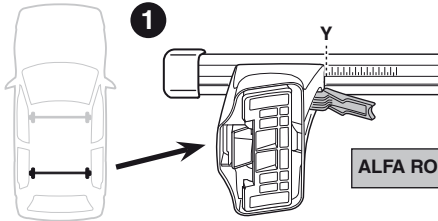

	Y
ALFA ROMEO 166, 4-dr Sedan, 98-03, 04-07	32,5

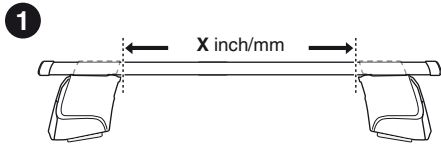
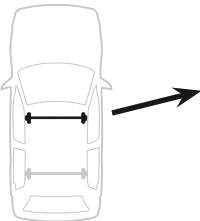
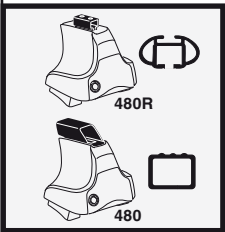

	X inch	X mm
ALFA ROMEO 166, 4-dr Sedan, 98-03, 04-07	37 <sup>5</sup> / <sub>8</sub> "	956 mm

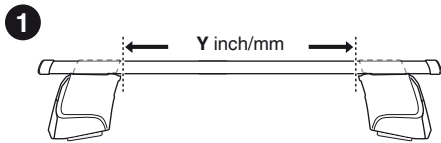
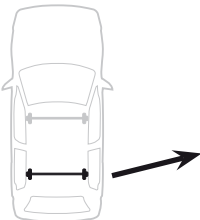

	Y inch	Y mm
ALFA ROMEO 166, 4-dr Sedan, 98-03, 04-07	38 <sup>3</sup> / <sub>8</sub> "	976 mm



# 4

ALFA ROMEO 166, 4-dr Sedan, 98-03, 04-07

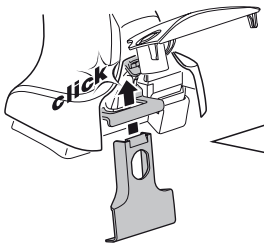
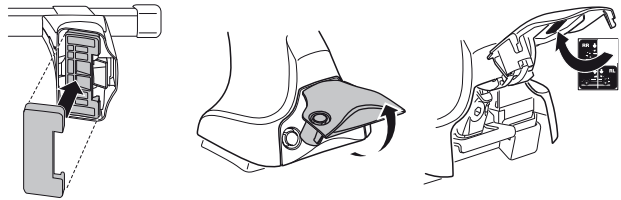
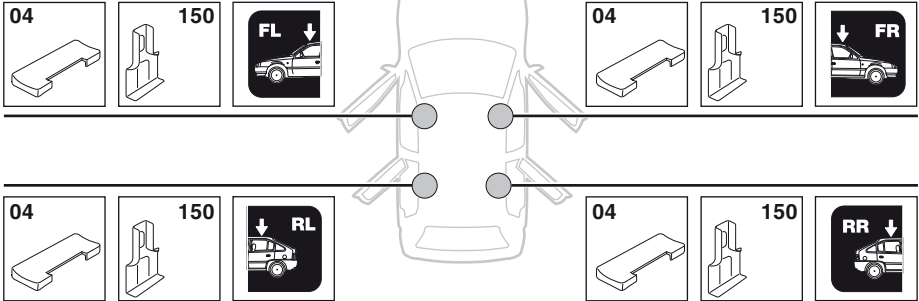

5



	X mm	Y mm	X inch	Y inch
ALFA ROMEO 166, 4-dr Sedan, 98-03, 04-07	200 mm	650 mm	7 <sup>7</sup> / <sub>8</sub> "	25 <sup>5</sup> / <sub>8</sub> "

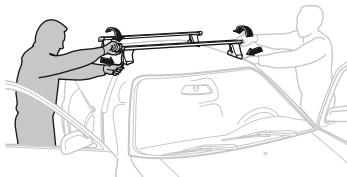
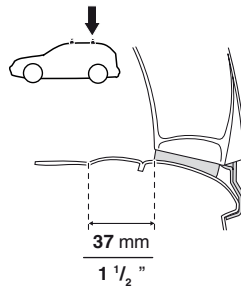
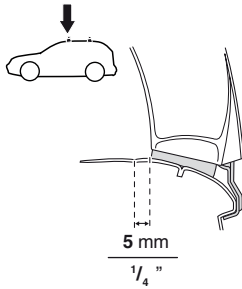
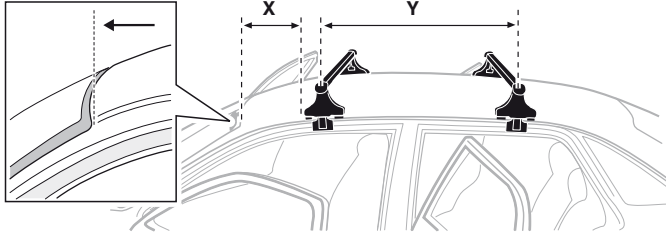

**GB/US** Tighten alternately

**D** Die Schrauben abwechselnd anziehen

**F** Serrer alternativement chaque côté

**NL** Afwisselend aan de linker- en de rechterkant aandraaien

**I** Alternare il serraggio delle viti

**E** Apretar alternativamente

**PT** Aperte alternadamente

**S** Dra åt växelvis

**FIN** Kierrä vuorotellen

**EST** Pinguldage vaheldumisi

**LAT** Pielieciet pamīšus

**LIT** Užsukinėkite pakaitomis

**PL** Śruby dokręcaj naprzemiennie

**RU** Затягивайте попеременно

**CZ** Pokręťta багаžníka dokręcaj dokręcaj naprzemiennie.

**SK** Doťahujte striedavo

**SLO** Privijajte izmenično.

**HR** Naizmjenično zategnite

**HU** Egymástól függetlenül szorítandó

**GR** Σφιγγετε εναλλάξ

**TR** Dönüşümlü sıkın

**中文** 交替拧紧

**한국어** 번갈아 가며 조이십시오.

**日本語** 交互に締め付けてください。

**ไทย** ชันโนแบบสลับ

6



480R/754



480

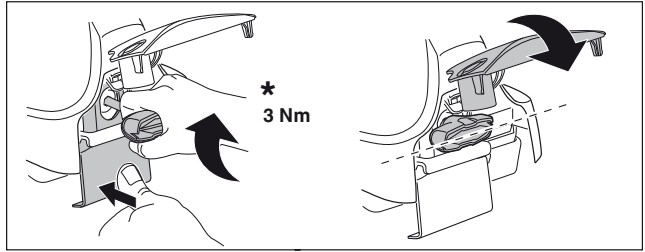
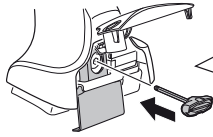

\*  
3 Nm



\*

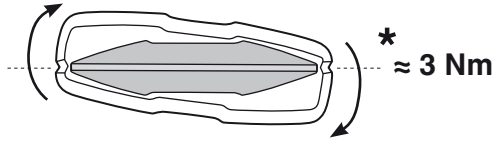

\*  
≈ 3 Nm

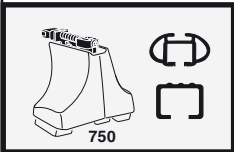
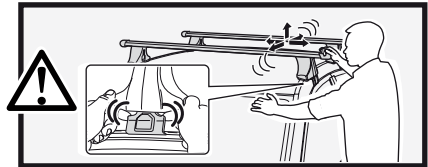

750

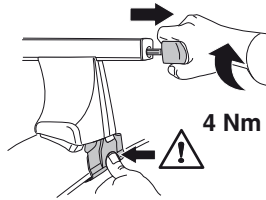

4 Nm

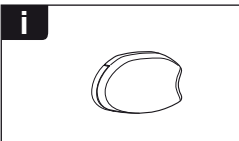
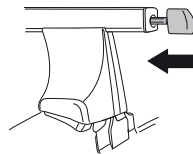

i

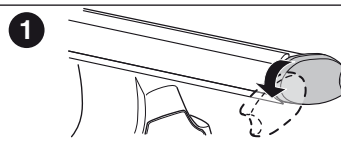

1

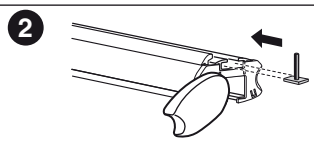

2

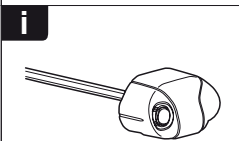

i

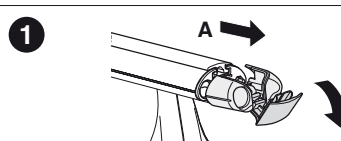

1

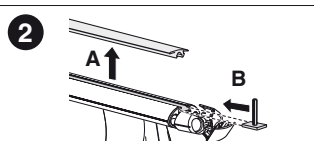

2

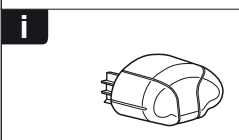

i

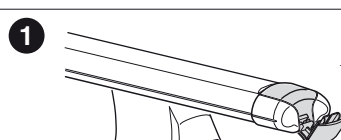

1

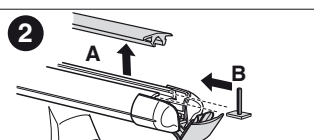

2



**THULE**  
SWEDEN  
**ONE  
KEY  
SYSTEM**



- 544 (x4)
- 596 (x6)
- 588 (x8)
- NA 510 (x10)
- EUR 452 (x12)
- ASIA



WW ▶ Thule Sweden AB, Box 69, 330 33 Hillerstorp, SWEDEN  
NA ▶ Thule Inc., 42 Silvermine Road, Seymour, Connecticut 06483, USA

info@thule.com  
customer.service@thule.com

www.thule.com