

# Kit 1396

KIA Rio (Mk II), 4-dr Sedan, 05- / \*06-

KIA Rio (Mk II), 5-dr Hatchback, 05-

KIA Rio Cinco, 5-dr Wagon, \*06-

\*North America

480R  
754

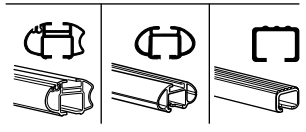
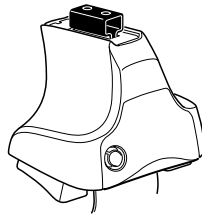

480

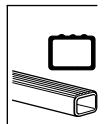
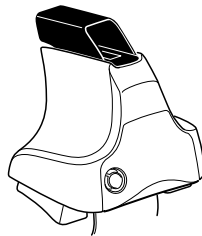

750

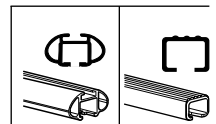
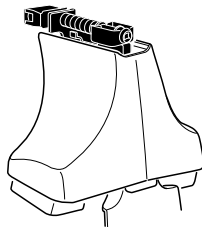

x1

x4

x4

x4

x4

**480R/754**

---

x1

x4

x4

x4

x4

**480**

---

x1

x4

x4

x4

x4

**750**

x2 x2 x2 x4	x2	x2 x2 x4 x4	x2 x2	x2

**765** x2

**776** x1

**232** x2

**775** x1

**231** x2

x1

**Kit**



**3**

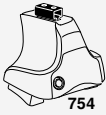

754

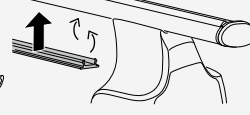
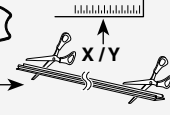

750

**1**

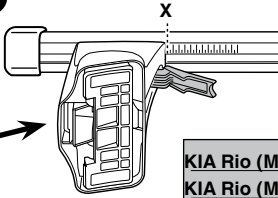
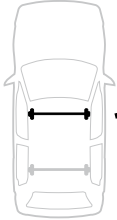

**2**

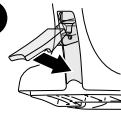

	X
<b>KIA Rio (Mk II), 4-dr Sedan, 05- / *06-</b>	<b>35</b>
<b>KIA Rio (Mk II), 5-dr Hatchback, 05-</b>	<b>35</b>
<b>KIA Rio Cinco, 5-dr Wagon, *06-</b>	<b>35</b>

**1**

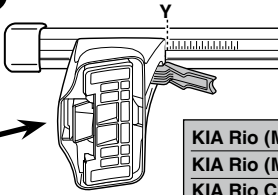

**2**

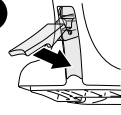

	Y
<b>KIA Rio (Mk II), 4-dr Sedan, 05- / *06-</b>	<b>33,5</b>
<b>KIA Rio (Mk II), 5-dr Hatchback, 05-</b>	<b>32,5</b>
<b>KIA Rio Cinco, 5-dr Wagon, *06-</b>	<b>32,5</b>



480R



480

**1**

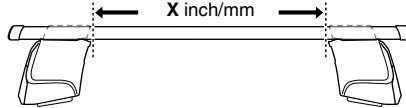
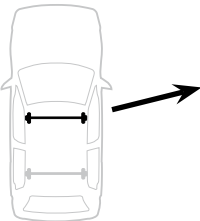

**2**

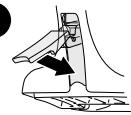

	X inch	X mm
<b>KIA Rio (Mk II), 4-dr Sedan, 05- / *06-</b>	<b>39 <sup>3</sup>/<sub>8</sub> "</b>	<b>1001 mm</b>
<b>KIA Rio (Mk II), 5-dr Hatchback, 05-</b>	<b>39 <sup>3</sup>/<sub>8</sub> "</b>	<b>1001 mm</b>
<b>KIA Rio Cinco, 5-dr Wagon, *06-</b>	<b>39 <sup>3</sup>/<sub>8</sub> "</b>	<b>1001 mm</b>

**1**

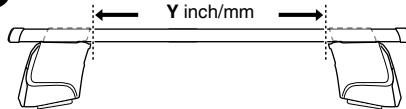
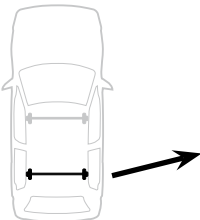

**2**

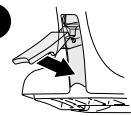

	Y inch	Y mm
<b>KIA Rio (Mk II), 4-dr Sedan, 05- / *06-</b>	<b>38 <sup>7</sup>/<sub>8</sub> "</b>	<b>986 mm</b>
<b>KIA Rio (Mk II), 5-dr Hatchback, 05-</b>	<b>38 <sup>3</sup>/<sub>8</sub> "</b>	<b>976 mm</b>
<b>KIA Rio Cinco, 5-dr Wagon, *06-</b>	<b>38 <sup>3</sup>/<sub>8</sub> "</b>	<b>976 mm</b>

# 4

KIA Rio (Mk II), 4-dr Sedan, 05- / \*06-

KIA Rio (Mk II), 5-dr Hatchback, 05-

KIA Rio Cinco, 5-dr Wagon, \*06-

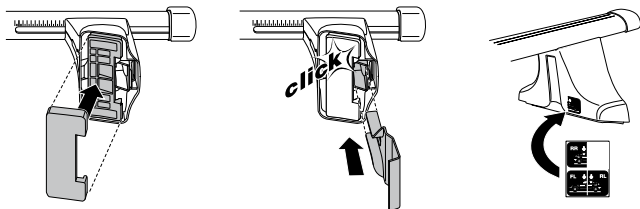
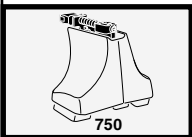
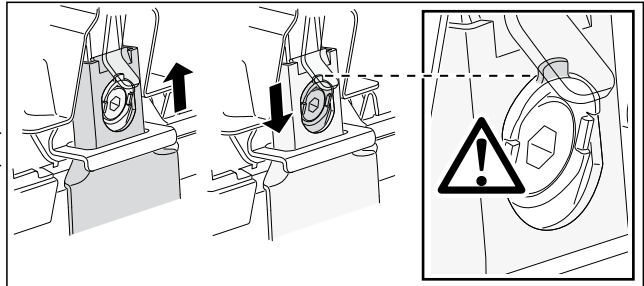
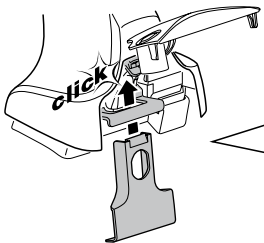
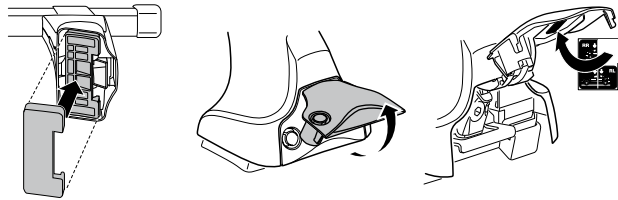
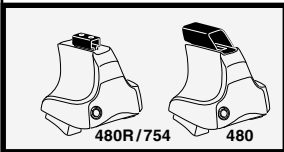
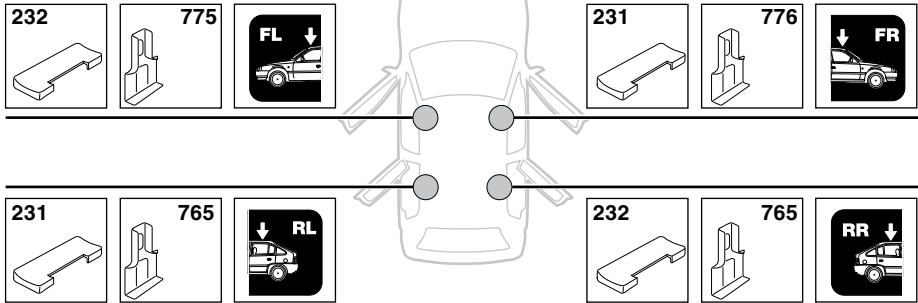

**5**



	X mm	Y mm	X inch	Y inch
<b>KIA Rio (Mk II), 4-dr Sedan, 05- / *06-</b>	<b>200 mm</b>	<b>650 mm</b>	<b>7 7/8"</b>	<b>25 5/8"</b>
<b>KIA Rio (Mk II), 5-dr Hatchback, 05-</b>	<b>215 mm</b>	<b>670 mm</b>	<b>8 1/2"</b>	<b>26 3/8"</b>
<b>KIA Rio Cinco, 5-dr Wagon, *06-</b>	<b>215 mm</b>	<b>670 mm</b>	<b>8 1/2"</b>	<b>26 3/8"</b>

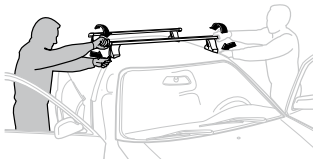
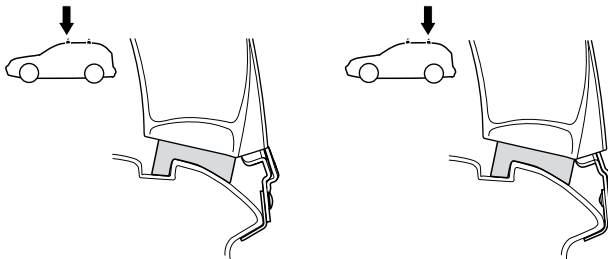
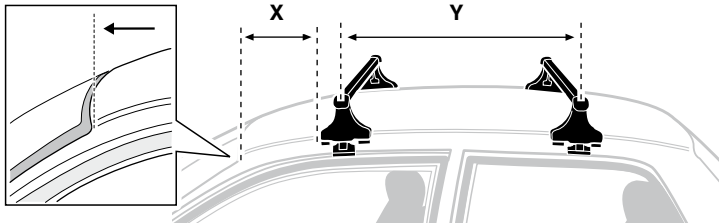

- |              |   |            |   |
|--------------|---|------------|---|
| <b>GB/US</b> | Tighten alternately                                     | <b>CZ</b>  | Pokręťte bagazníka dokřečaj dokřečaj napržeemennie. |
| <b>D</b>     | Die Schrauben abwechselnd anziehen                      | <b>SK</b>  | Dofahujte striedavo                                 |
| <b>F</b>     | Serrer alternativement chaque côté                      | <b>SLO</b> | Privijajte izmenično.                               |
| <b>NL</b>    | Afwisselend aan de linker- en de rechterkant aandraaien | <b>HR</b>  | Naizmenično zategnite                               |
| <b>I</b>     | Alternare il serraggio delle viti                       | <b>HU</b>  | Egymástól függetlenül szorítandó                    |
| <b>E</b>     | Apretar alternativamente                                | <b>GR</b>  | Σφιγγετε εναλλάξ                                    |
| <b>PT</b>    | Aperite alternadamente                                  | <b>TR</b>  | Dönüşümlü sıkın                                     |
| <b>S</b>     | Dra åt växelvis   | <b>中文</b>  | 交替拧紧  |
| <b>FIN</b>   | Kierrä vuorotellen                                      | <b>한국어</b> | 번갈아가며 조이십시오.  |
| <b>EST</b>   | Pinguldage vaheldumisi                                  | <b>日本語</b> | 交互に締め付けてください。                                       |
| <b>LAT</b>   | Pievelciet pamišus                                      | <b>ไทย</b> | ขันในแบบสลับ  |
| <b>LIT</b>   | Užsukinėkite pakaitomis                                 |            |   |
| <b>PL</b>    | Śruby dokręcaj naprzemiennie                            |            |   |
| <b>RU</b>    | Затягивайте попеременно                                 |            |   |

6



480R/754



480

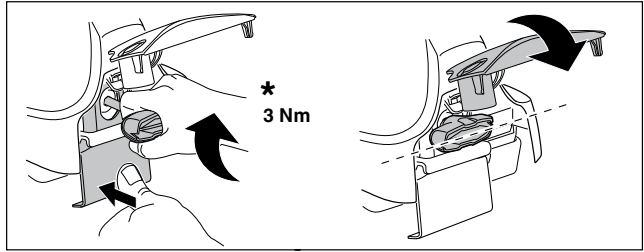
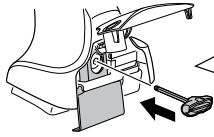

\*  
3 Nm



\*

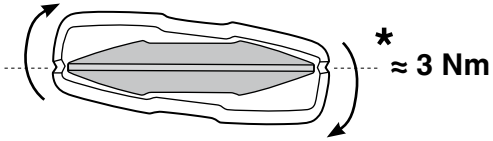

\*  
≈ 3 Nm

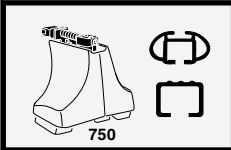
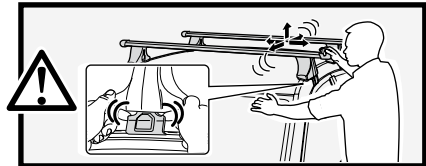

750

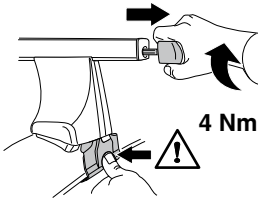

4 Nm

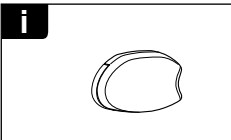
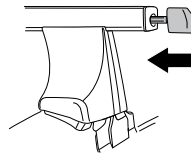

i

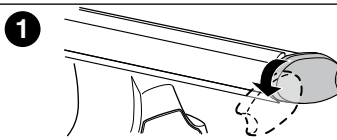

1

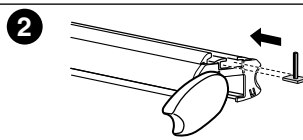

2

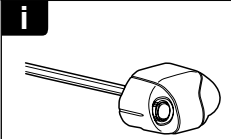

i

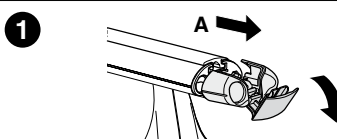

1

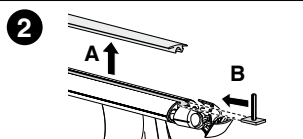

2

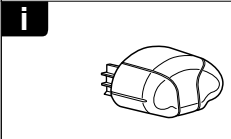

i

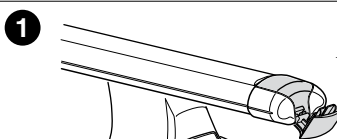

1

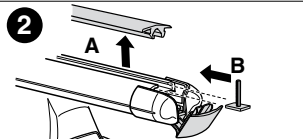

2



**THULE**  
SWEDEN  
**ONE  
KEY  
SYSTEM**



		544	(x4)
		596	(x6)
		588	(x8)
NA		510	(x10)
EUR		452	(x12)
ASIA			



WW ▶ Thule Sweden AB, Box 69, 330 33 Hillerstorp, SWEDEN  
NA ▶ Thule Inc., 42 Silvermine Road, Seymour, Connecticut 06483, USA

info@thule.com  
customer.service@thule.com

www.thule.com

503-1396-02