

Kit 1610

KIA Magentis, 4-dr Sedan, 06-

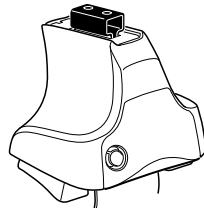

480R Rapid Traverse
754 Rapid System

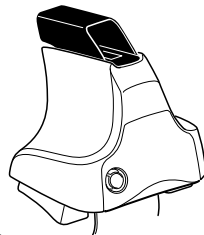
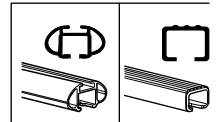

480 Traverse

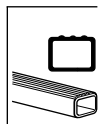

480R Rapid Traverse x4
754 Rapid System x4

480 Traverse x4

- Bar (top): x2
- Bar (middle): x2
- Nut (top): x2
- Washer (top): x2
- Washer (middle): x2
- Screw (top): x1
- Screw (middle): x2
- Screw (bottom): x2
- Washer (bottom): x2
- Bar (right): x2
- Nut (right): x2
- Washer (right): x2
- Screw (right): x2
- Washer (right): x2
- Washer (bottom): x4
- Screw (bottom): x4
- Washer (bottom): x4

- Bag: x1
- Bracket (left): 1098 x4
- Bracket (top): 140 x2
- Bracket (bottom): 141 x2
- Diagram: x1

Kit

1

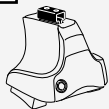

480R Rapid Traverse
754 Rapid System



480 Traverse

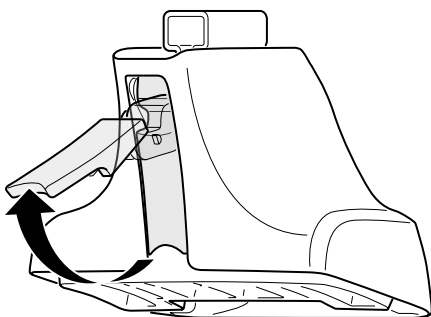

2

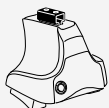

480R Rapid Traverse
754 Rapid System



480 Traverse

+

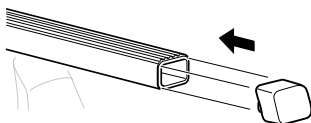
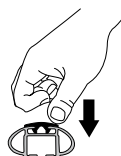
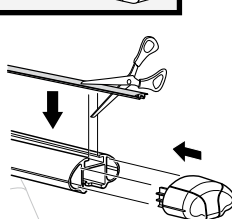
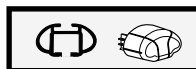
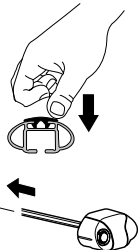
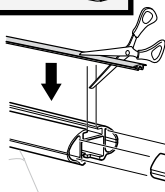
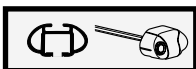
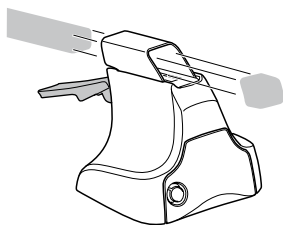
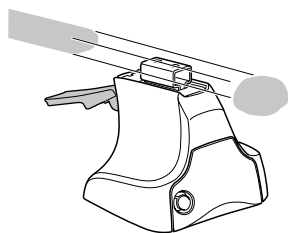

3

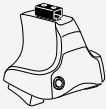

754 Rapid System

1

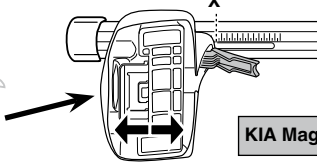
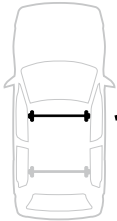

2

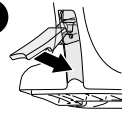

KIA Magentis, 4-dr Sedan, 06-

X

37

1

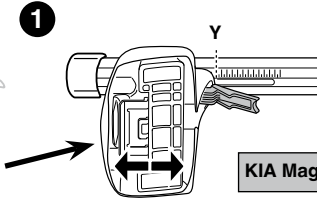
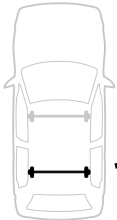

2

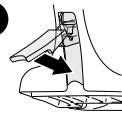

KIA Magentis, 4-dr Sedan, 06-

Y

36



480R Rapid Traverse



480 Traverse

1

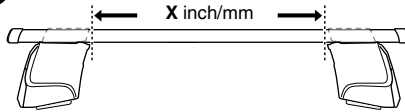

2

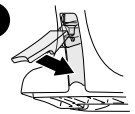

KIA Magentis, 4-dr Sedan, 06-

X inch

X mm

40 1/4"

1021 mm

1

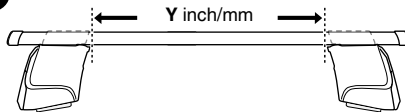

2

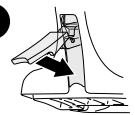

KIA Magentis, 4-dr Sedan, 06-

Y inch

Y mm

39 3/4"

1011 mm

4

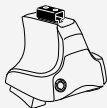

480R Rapid Traverse
754 Rapid System



480 Traverse

KIA Magentis, 4-dr Sedan, 06-

140



1098



141



1098



141



1098



140



1098

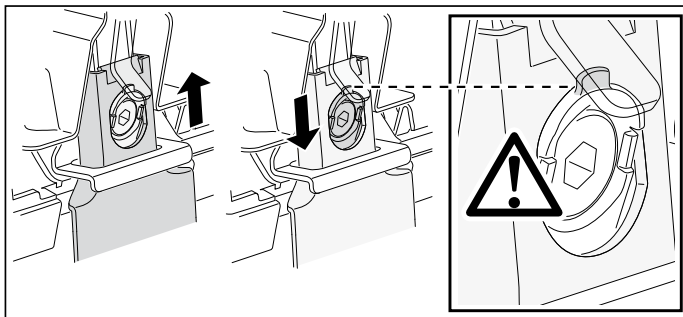
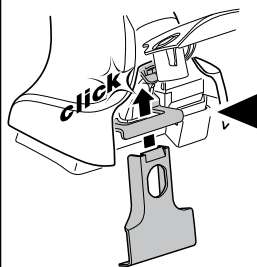
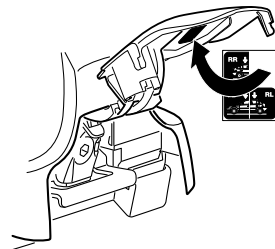
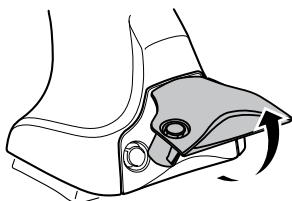
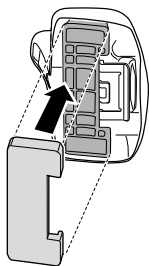

5

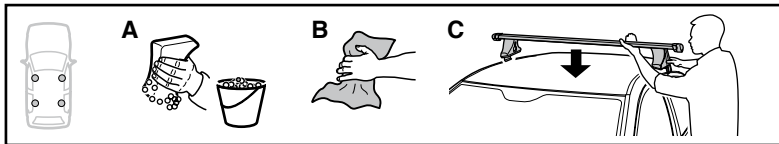

	X mm	Y mm	X inch	Y inch
KIA Magentis, 4-dr Sedan, 06-	250 mm	670 mm	9 7/8"	26 3/8"

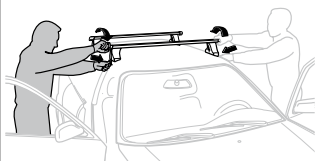
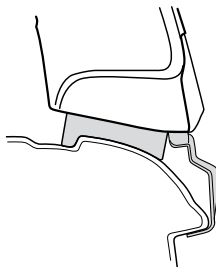
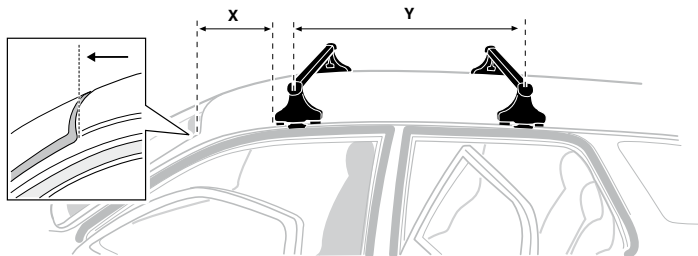

GB/US Tighten alternately

D Die Schrauben abwechselnd anziehen

F Serrer alternativement chaque côté

NL Afwisselend aan de linker- en de rechterkant aandraaien

I Alternare il serraggio delle viti

E Apretar alternativamente

PT Aperte alternadamente

S Dra åt växelvis

FIN Kierrä vuorotellen

EST Pinguldage vaheldumisi

LAT Pieļieciet pamāšus

LIT Užsukinkite pakaitomis

PL Śruby dokręcaj naprzemiennie

RU Затягивайте попеременно

CZ Pokrétla bagazníka dokręcaj dokręcaj naprzemiennie.

SK Dotahujte striedavo

SLO Privijajte izmenično.

HR Naizmjenočno zategnite

HU Egy mástól függetlenül szorítandó

GR Σφιγχετε εναλλάξ

TR Dönüşümlü sıkın

中文 交替拧紧

한국어 번갈아 가며 조이십시오.

日本語 交互に締め付けてください。

ไทย ชับในแบบสลับ

6

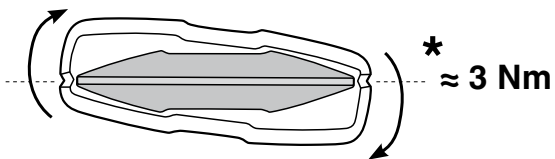
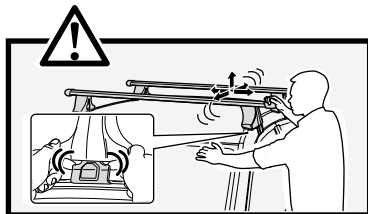
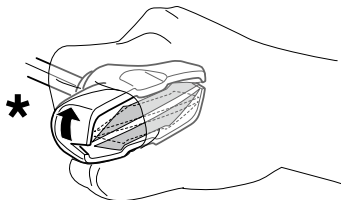
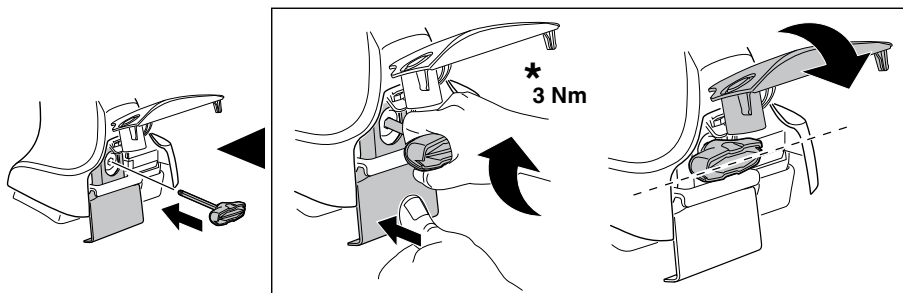
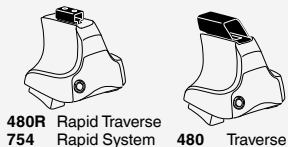

7

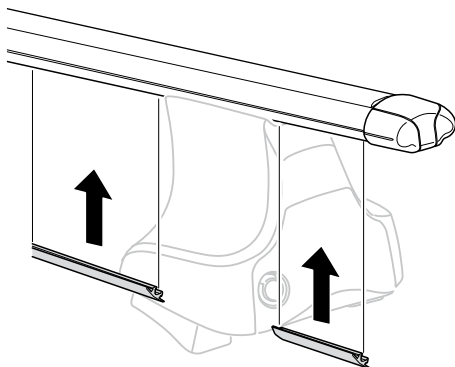
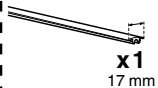

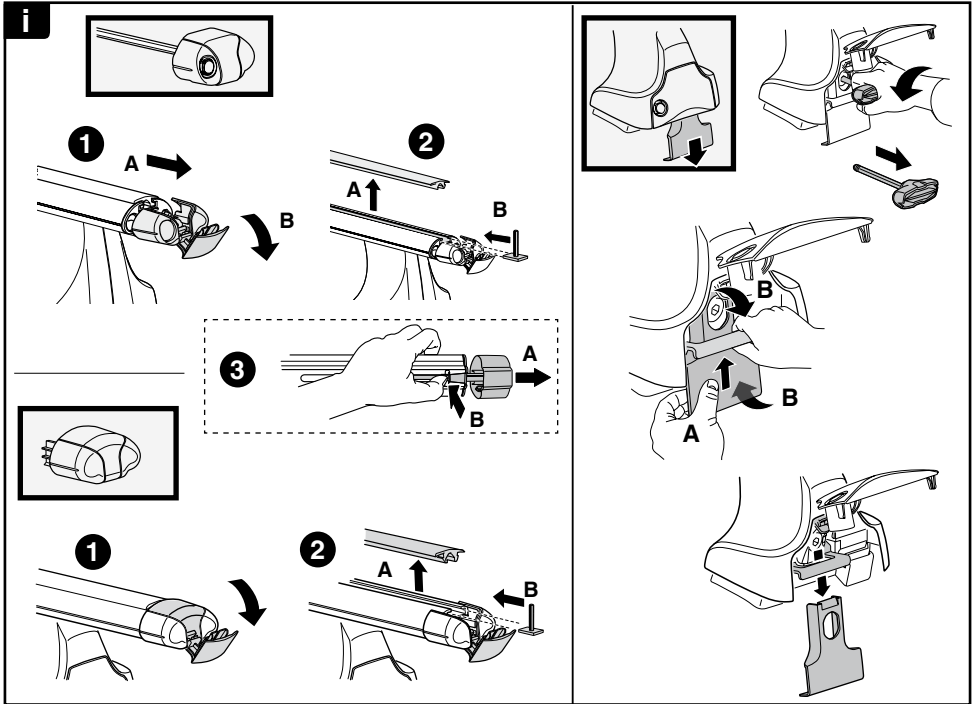
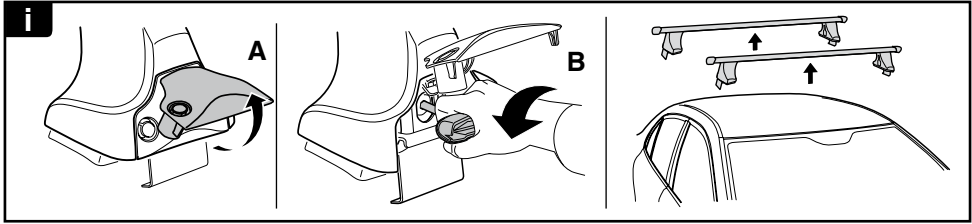

THULE
SWEDEN
**ONE
KEY
SYSTEM**

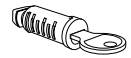
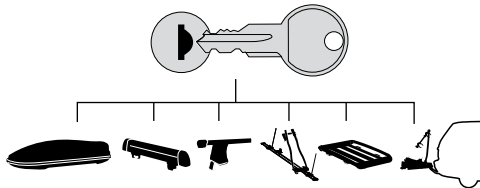

- 544** (x4)
- 596** (x6)
- 588** (x8)
- NA **510** (x10)
- EUR **452** (x12)
- ASIA

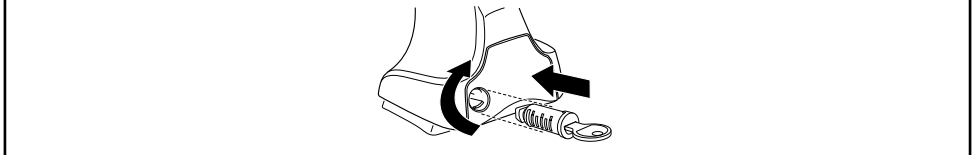

WW ▶ Thule Sweden AB, Box 69, 330 33 Hillerstorp, SWEDEN
NA ▶ Thule Inc., 42 Silvermine Road, Seymour, Connecticut 06483, USA

info@thule.com
customer.service@thule.com

www.thule.com