

Kit 1298



480R/754 480 750

Lexus RX 300/400h (Mk II), 5-dr SUV, 03-09



480R/754 480 -

Lexus RX 350/450h (Mk III), 5-dr SUV, 09-



480R/754 480 750

TOYOTA Harrier (Mk II), 5-dr SUV, 03-09

**480R
754**

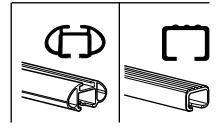
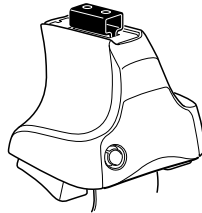

480

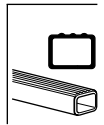
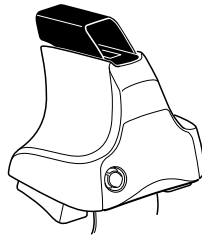

750

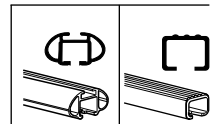
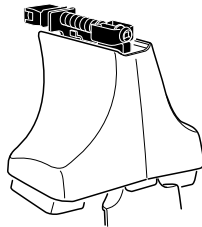

Kit

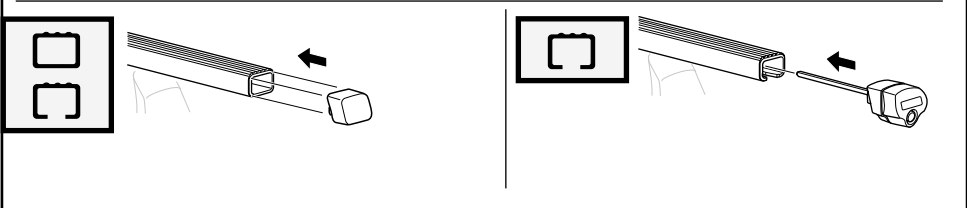
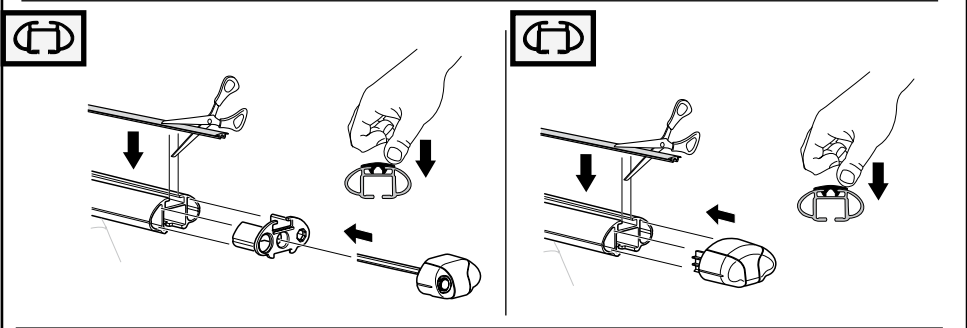
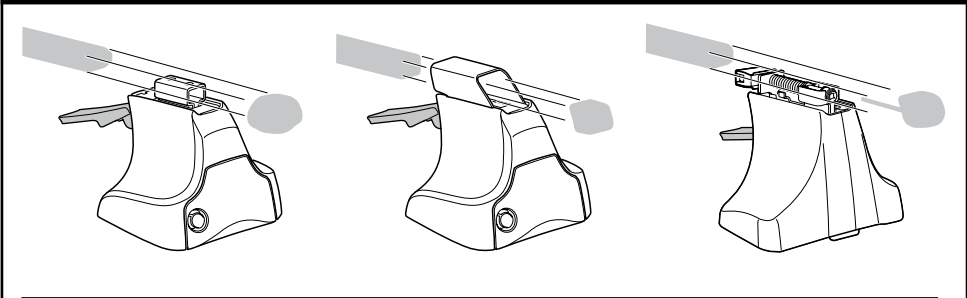
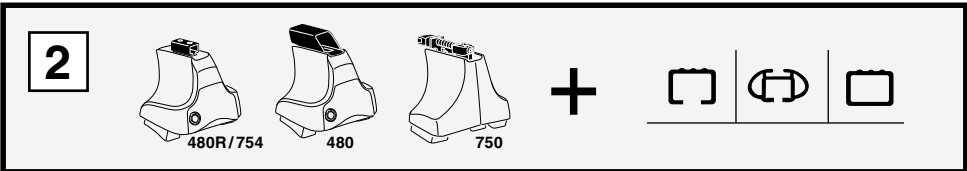
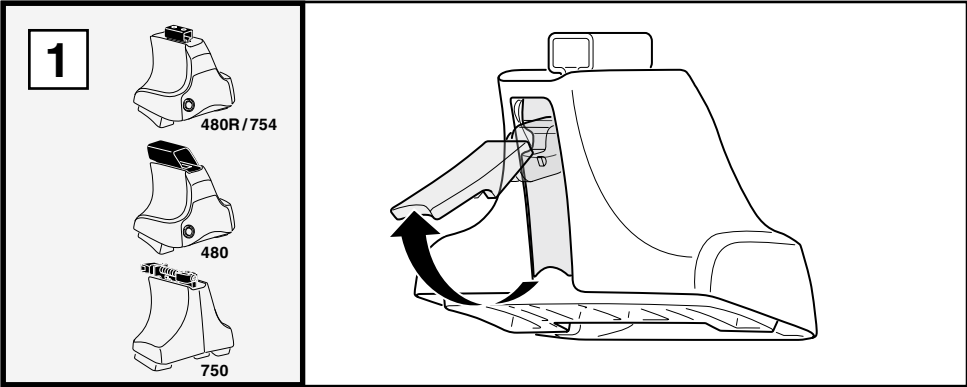

3

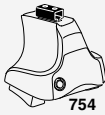

1

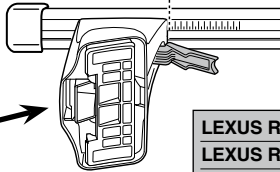
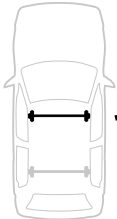

2

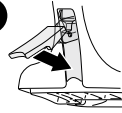

LEXUS RX 300/400h (Mk II), 5-dr SUV, 03-09

X

LEXUS RX 350/450h (Mk III), 5-dr SUV, 09-

36

TOYOTA Harrier (Mk II), 5-dr SUV, 03-09

36

1

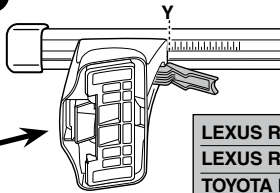

2

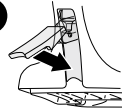

LEXUS RX 300/400h (Mk II), 5-dr SUV, 03-09

Y

LEXUS RX 350/450h (Mk III), 5-dr SUV, 09-

35,5

TOYOTA Harrier (Mk II), 5-dr SUV, 03-09

35,5



480R



480

1

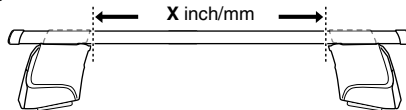
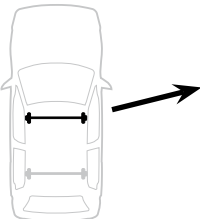

2

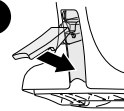

LEXUS RX 300/400h (Mk II), 5-dr SUV, 03-09

X inch

X mm

LEXUS RX 350/450h (Mk III), 5-dr SUV, 09-

39 3/4"

1011 mm

TOYOTA Harrier (Mk II), 5-dr SUV, 03-09

39 3/4"

1011 mm

1

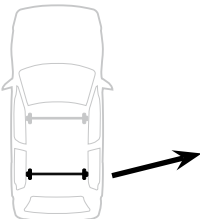

2

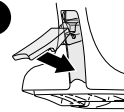

LEXUS RX 300/400h (Mk II), 5-dr SUV, 03-09

Y inch

Y mm

LEXUS RX 350/450h (Mk III), 5-dr SUV, 09-

39 5/8"

1006 mm

TOYOTA Harrier (Mk II), 5-dr SUV, 03-09

39 5/8"

1006 mm

4

LEXUS RX 300/400h (Mk II), 5-dr SUV, 03-09

LEXUS RX 350/450h (Mk III), 5-dr SUV, 09-

TOYOTA Harrier (Mk II), 5-dr SUV, 03-09

46



568

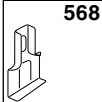

46

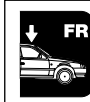
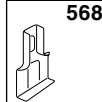

06



569

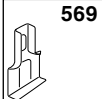

06

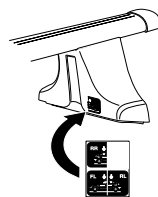
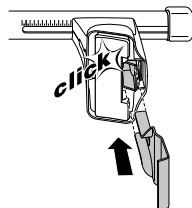
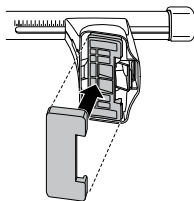
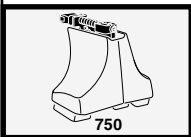
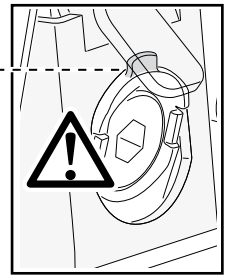
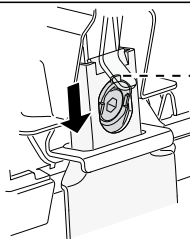
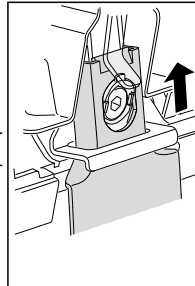
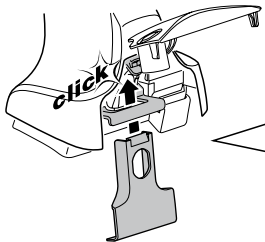
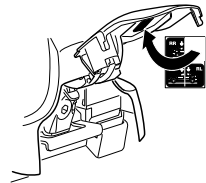
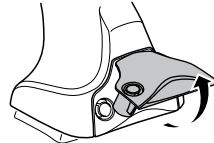
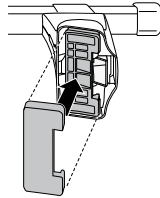
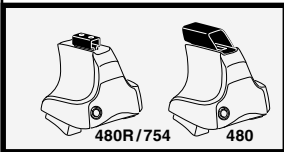
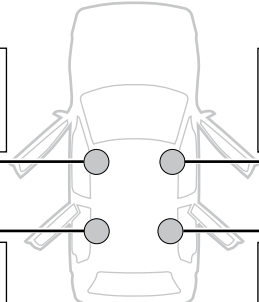
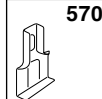

5

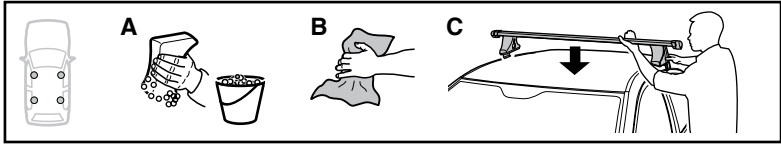

	X mm	Y mm	X inch	Y inch
LEXUS RX 300/400h (Mk II), 5-dr SUV, 03-09	215 mm	660 mm	8 1/2"	26"
LEXUS RX 350/450h (Mk III), 5-dr SUV, 09-	215 mm	660 mm	8 1/2"	26"
TOYOTA Harrier (Mk II), 5-dr SUV, 03-09	215 mm	660 mm	8 1/2"	26"

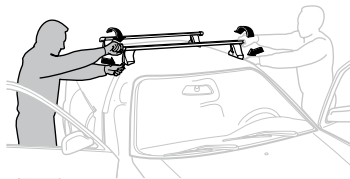
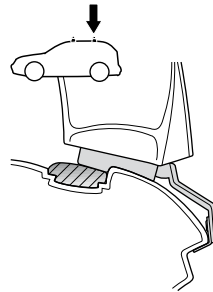
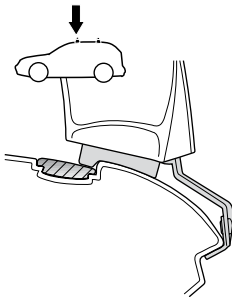
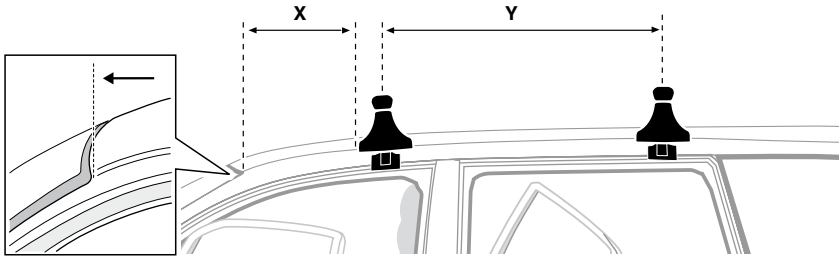

GB/US Tighten alternately

D Die Schrauben abwechselnd anziehen

F Serrer alternativement chaque côté

NL Afwisselend aan de linker- en de rechterkant aandraaien

I Alternare il serraggio delle viti

E Apertar alternativamente

PT Aperte alternadamente

S Dra åt växelvis

FIN Kierrä vuorotellen

EST Pinguldage vaheldumisi

LAT Pielieciet pamišus

LIT Užsukinkite pakaitomis

PL Śruby dokręcaj naprzemiennie

RU Затягивайте попеременно

CZ Pokręťte bagážníka dokręcaj dokręcaj naprzemiennie.

SK Doťahujte striedavo

SLO Privijajte izmenično.

HR Naizmjenično zategnite

HU Egymástól függetlenül szorítandó

GR Σφιγγετε εναλλάξ

TR Dönüşümlü sıkın

中文 交替拧紧

한국어 번갈아 가며 조이십시오.

日本語 交互に締め付けてください。

ไทย ชั้ไนแบบสลับ

6

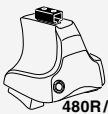

480R/754



480

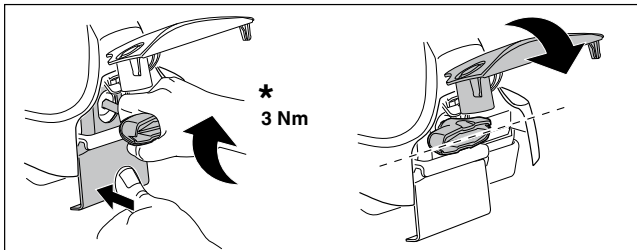
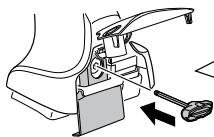

*
3 Nm

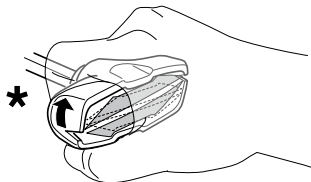

*

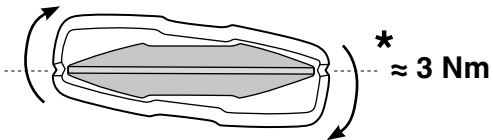

*
≈ 3 Nm

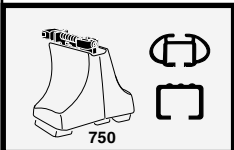
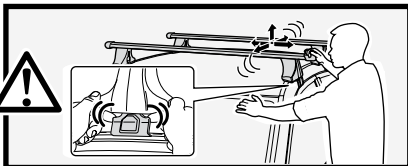

750

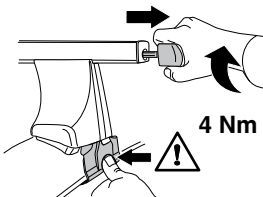

4 Nm

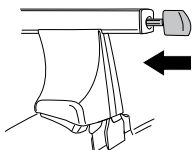

7



x1
17 mm

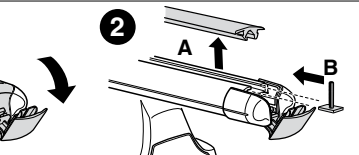
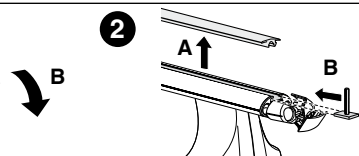
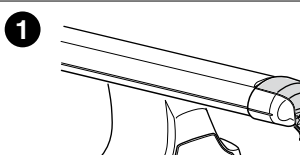
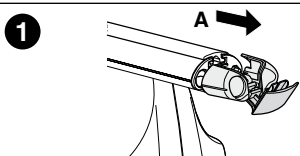
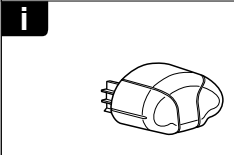
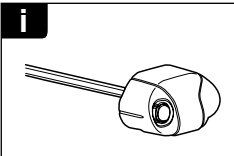
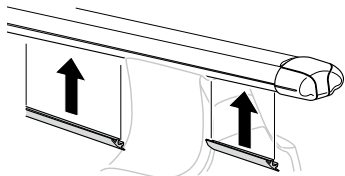

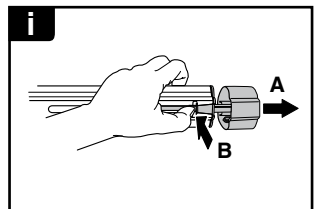
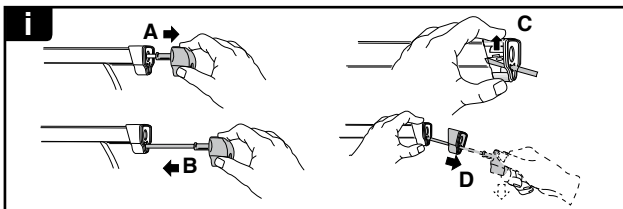
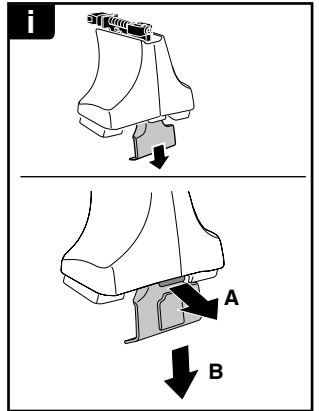
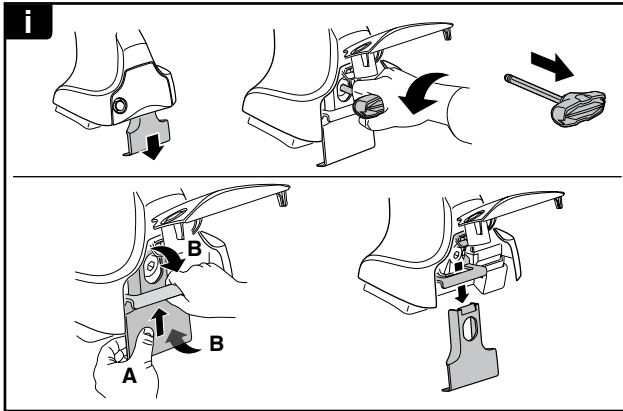
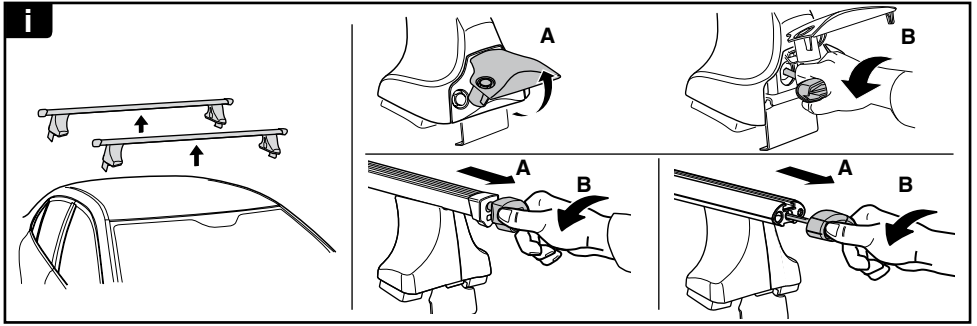

THULE
SWEDEN
**ONE
KEY
SYSTEM**

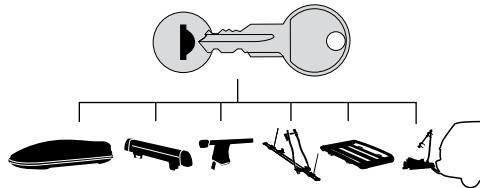

- 544 (x4)
- 596 (x6)
- 588 (x8)
- NA 510 (x10)
- EUR 452 (x12)
- ASIA

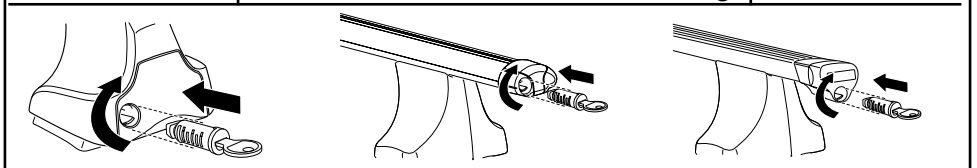

WW ▶ Thule Sweden AB, Box 69, 330 33 Hillerstorp, SWEDEN
NA ▶ Thule Inc., 42 Silvermine Road, Seymour, Connecticut 06483, USA

info@thule.com
customer.service@thule.com

www.thule.com

503-1298-02