

GB Fitting instructions
D Montageanleitung
F Instructions de montage
NL Montage-instructies
I Istruzioni per il montaggio
E Instrucciones de montaje
PT Instruções de Montagem
S Monteringsanvisning
FIN Asennusohje
EST Paigaldusjuhend
LAT Stiprināšanas instrukcija
LIT Pritvirtinimo instrukcijos
PL Instrukcja montażu
RU Инструкции по установке
CZ Návod na montáž

SK Návod na montáž
SLO Navodila za pritrjevanje
HR Uputa za sastavljanje
HU A felszerelés módja
GR Οδηγίες συναρμολόγησης
TR Montaj talimatları
中文 安装说明
日本語 取扱(取付)説明書
한국어 장착 지침
ไทย คำแนะนำการติดตั้ง

OutRide

561

561000



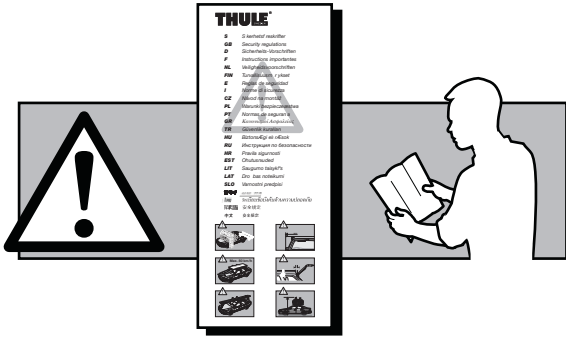

GB Do not mount bikes with carbon fibre fork.
D Keine Fahrräder mit Carbonfaser-gabeln montieren.
F Ne pas monter des vélos équipés de fourche avant en fibre de carbone.
NL Fietsen met een voorvork van koolstofvezel mogen niet worden gemonteerd.

I Non montare biciclette con forcelle anteriori in fibra di carbonio.
E No monte bicicletas con horquilla delantera de fibra de carbono.
PT Não utilizar para bicicletas com garfo dianteiro de fibra de carbono.
S Montera inte cyklar med framgaffel av kolfiber.
FIN Älä kiinnitä polkupyöriä, joissa on hiilikuituinen etuhaarukka.
EST Ärge paigaldage jalgrattaid, millel on süsinikkiust esihakvel.
LAT Nenostipriniet velosipēdus ar oglekļa šķiedras priekšējo dakšu.
LIT Netvirtinkite dviračių, kurių priekinės šakės iš anglies pluošto.
PL Nie montować rowerów z przednim widelcem wykonanym z włókien węglowych.
RU закреплять велосипеды с передней вилкой из углеродного волокна.
CZ Neupínajte jízdní kola s přední vidlicí z uhlíkového vlákna.
SK Nepripievňujte bicykle, ktoré majú prednú vidlicu z uhlíkových vlákien.
SLO Ne pritrujete koles s karbonskimi sprednjimi vilicami.
HR Ne montirajte bicikle čija je prednja vilica izrađena od ugljičnih vlakana.
HU Ne szereljük fel a szénszállas villájú kerékpárokat.
GR Μην προσαρτάτε ποδήλατα με μπροστινό πιρούνι από ανθρακονήματα.
TR Karbon fiber ön çatallı bisiklet yüklemeyin
 中文 请不要装载采用碳纤维前叉的自行车
 日本語 カーボンファイバー製フロントフォーク付きサイクルを装着しないでください。
 한국어 탄소섬유 전면 포크로 자전거를 장착하지 마십시오
 ไทย อย่ายึดติดตรึงจักรยานกับก้านปูด้านหน้าที่ทำจากคาร์บอนไฟเบอร์

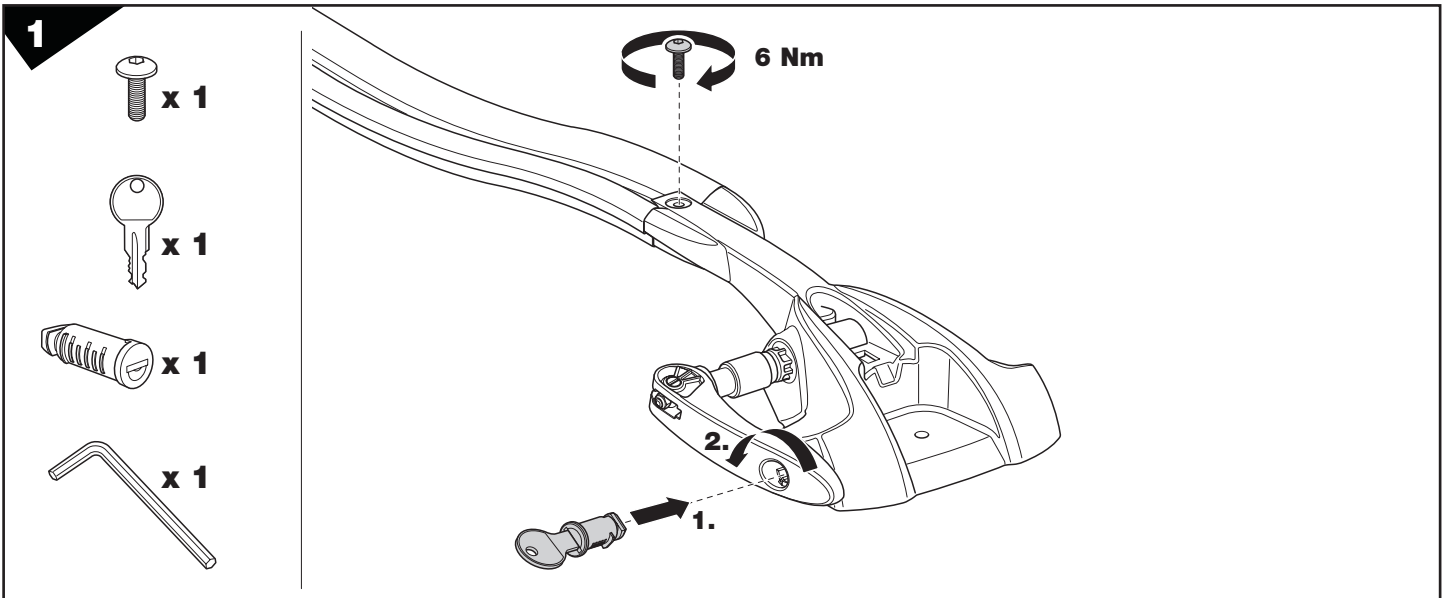
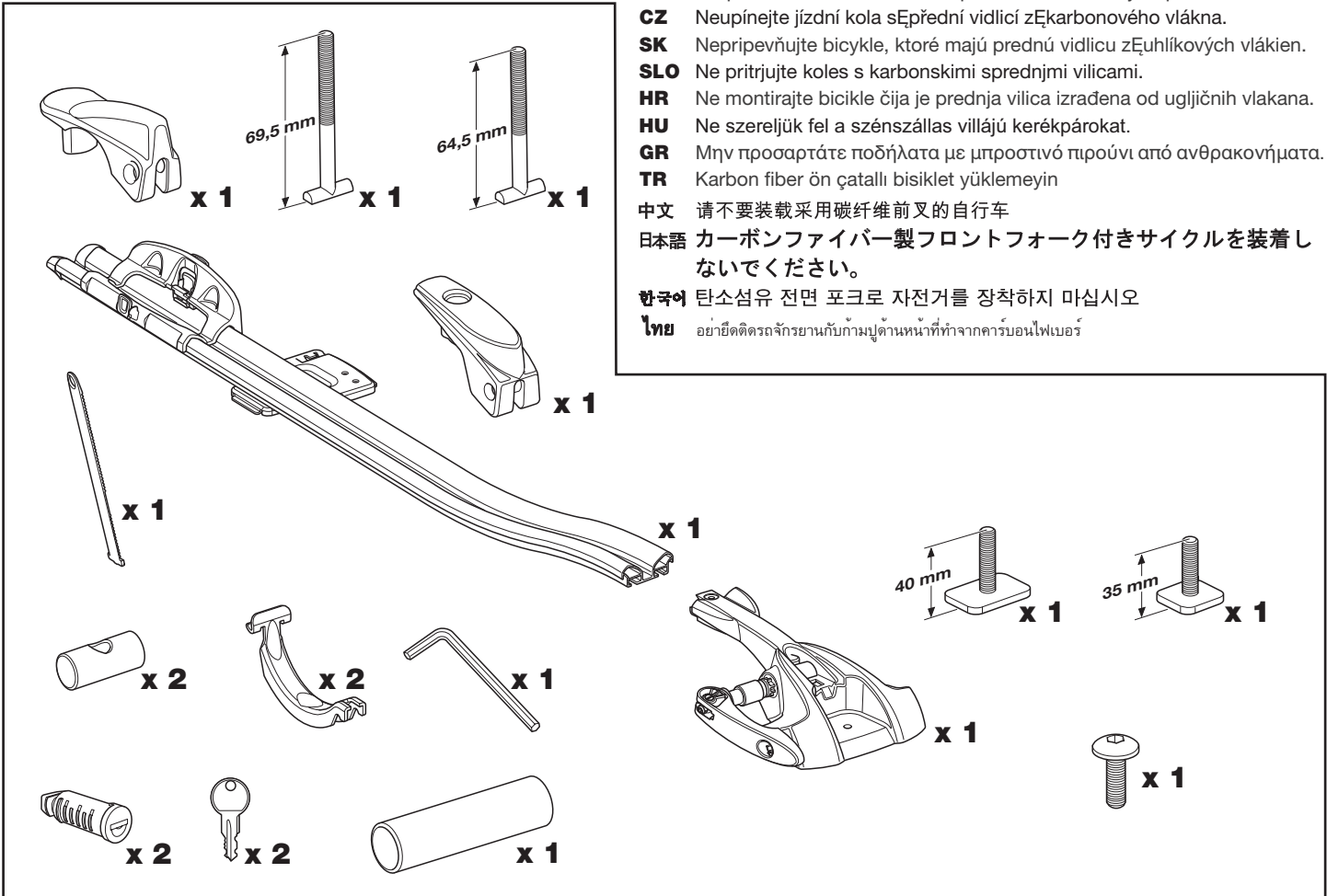

2

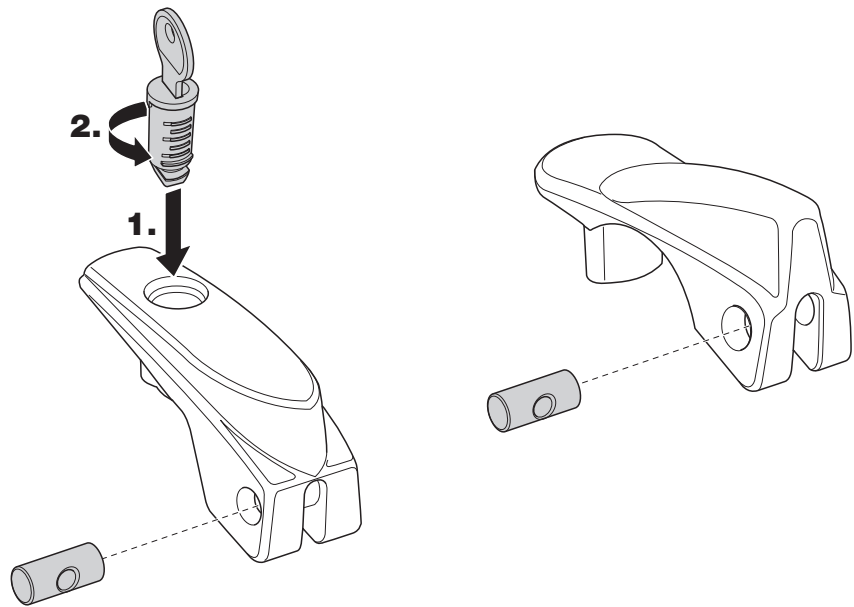
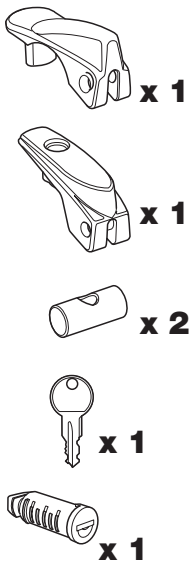

?

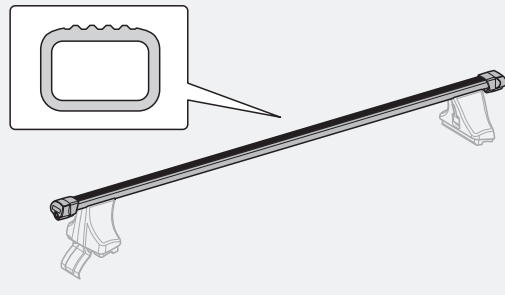
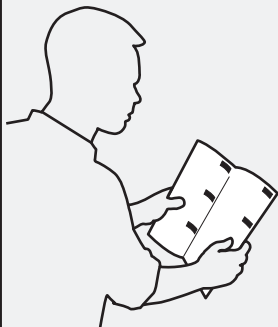

3-5

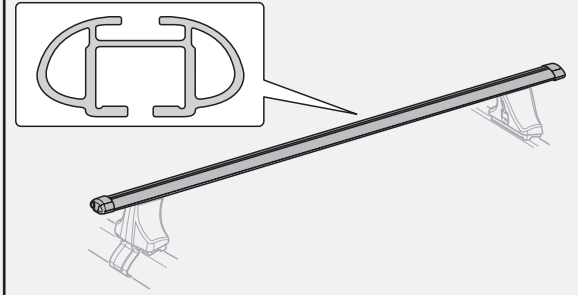
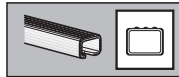

6-7

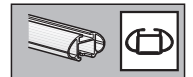

3

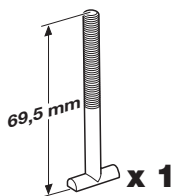
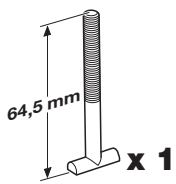

- * **GB** Only a few turns
- * **D** Nur wenige Umdrehungen
- * **F** Quelques tours uniquement
- * **NL** Slechts enkele slagen
- * **I** Solo qualche giro
- * **E** Sólo algunas vueltas
- * **PT** Noções básicas
- * **S** Endast några varv
- * **FIN** Vain muutama kierros
- * **EST** Ainult mõni pööre
- * **LAT** Tikai daži apgriezieni
- * **LIT** Tik keli pasukimai
- * **PL** Wystarczy kilka obrotów
- * **RU** Достаточно нескольких оборотов
- * **CZ** Pouze několik otáček
- * **SK** Len niekoľko otáčok
- * **SLO** Le nekaj obratov
- * **HR** Samo nekoliko okreta

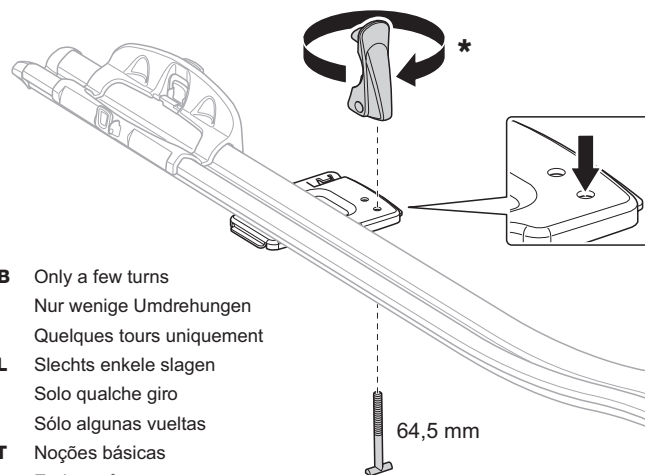

- * **HU** Csak néhány fordítás
- * **GR** Μόνο μερικές στροφές
- * **TR** Yalnız birkaç kez çevirme
- * **中文** 只有几个转向
- * **한국어** 두 세번만
- * **日本語** 数回転のみ
- * **ไทย** หมุนเพียงไม่กี่รอบ

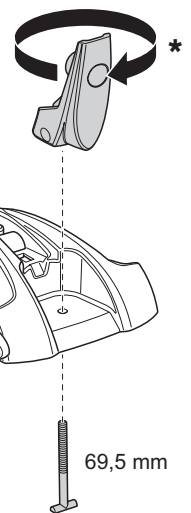
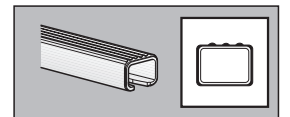

4

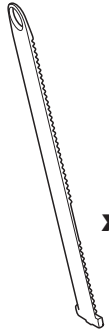

x 1

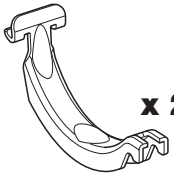

x 2

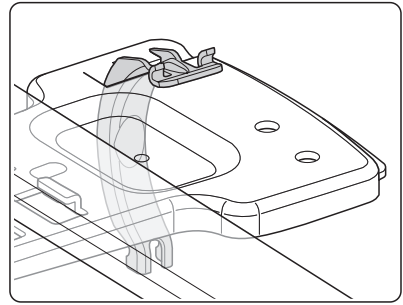
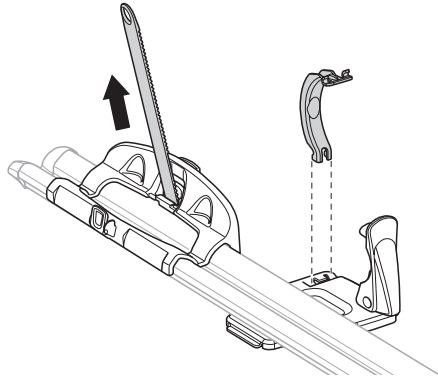
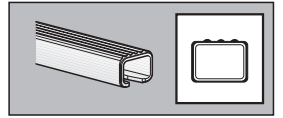
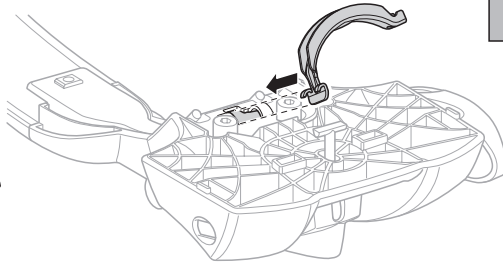
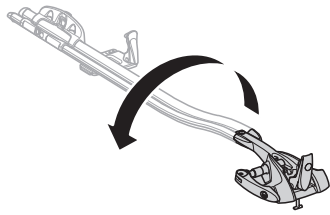

5

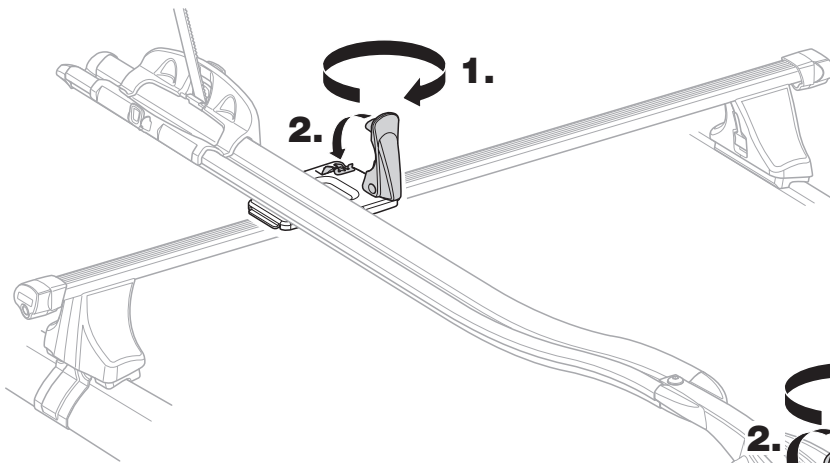
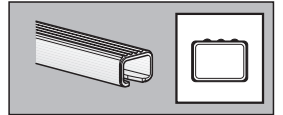
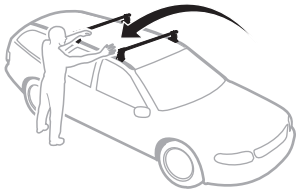

1.

2.

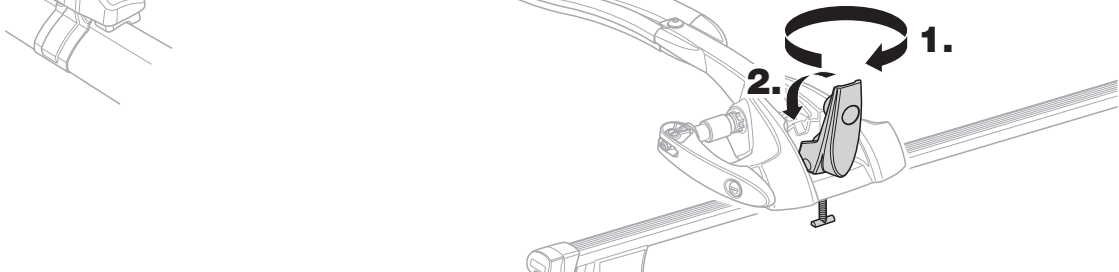

1.

2.

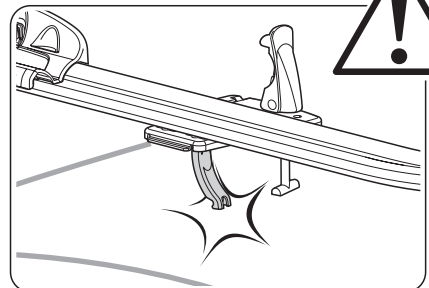
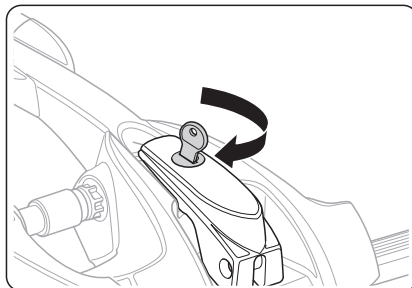
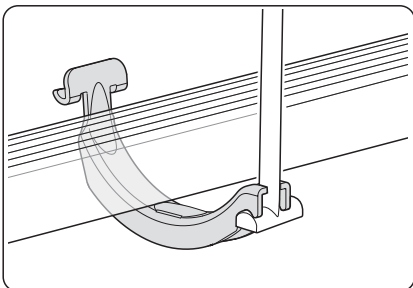

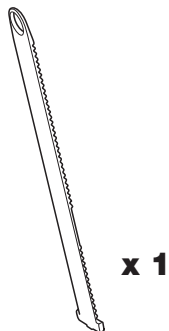
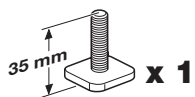
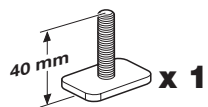
6

- * **GB** Only a few turns
- * **D** Nur wenige Umdrehungen
- * **F** Quelques tours uniquement
- * **NL** Slechts enkele slagen
- * **I** Solo qualche giro
- * **E** Sólo algunas vueltas
- * **PT** Noções básicas
- * **S** Endast några varv
- * **FIN** Vain muutama kierros
- * **EST** Ainult mõni pööre
- * **LAT** Tikai daži apgriezieni
- * **LIT** Tik keli pasukimai
- * **PL** Wystarczy kilka obrotów
- * **RU** Достаточно нескольких оборотов
- * **CZ** Pouze několik otáček
- * **SK** Len niekoľko otáčok
- * **SLO** Le nekaj obratov
- * **HR** Samo nekoliko okreta

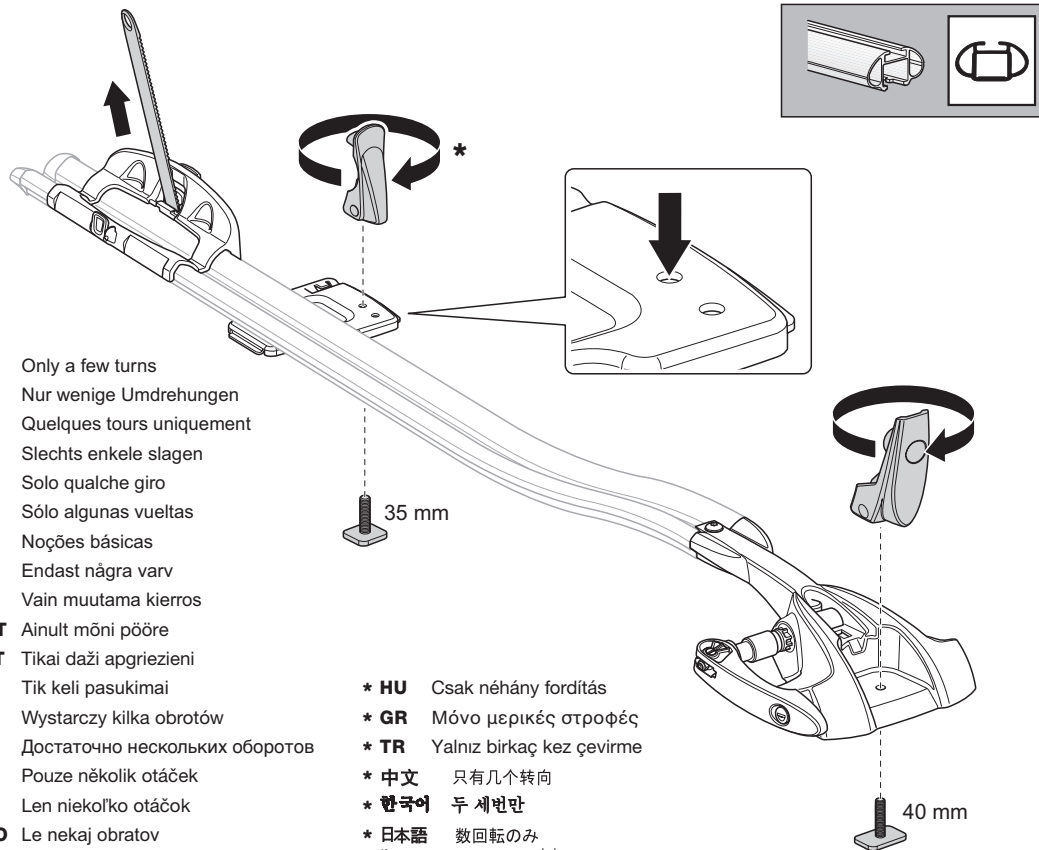

- * **HU** Csak néhány fordítás
- * **GR** Μόνο μερικές στροφές
- * **TR** Yalnız birkaç kez çevirme
- * **中文** 只有几个转向
- * **한국어** 두 세번만
- * **日本語** 数回転のみ
- * **ไทย** หมุนเพียงไม่กี่รอบ

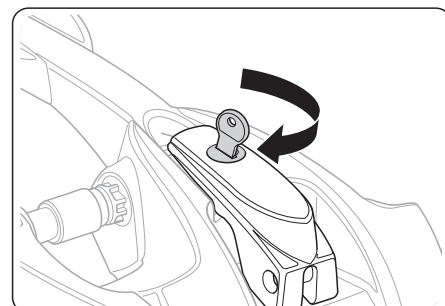
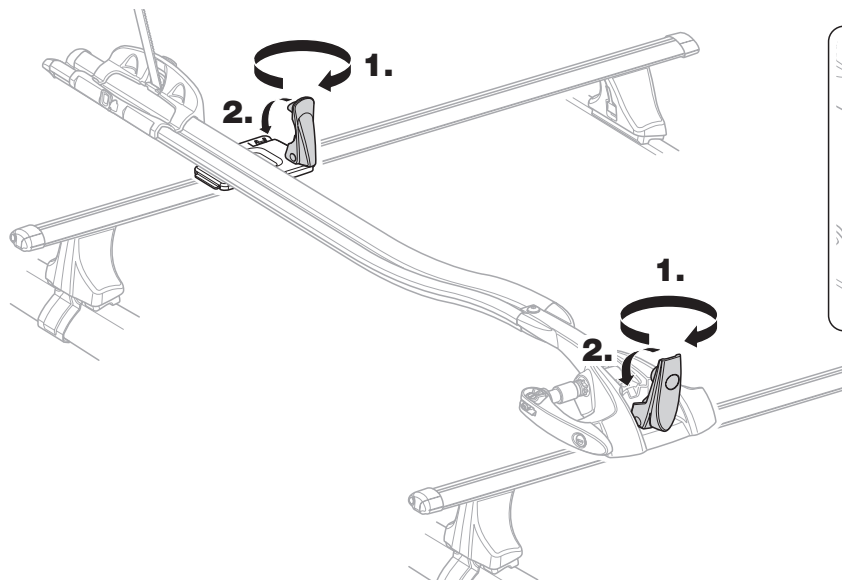
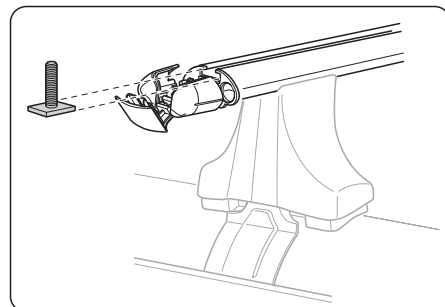
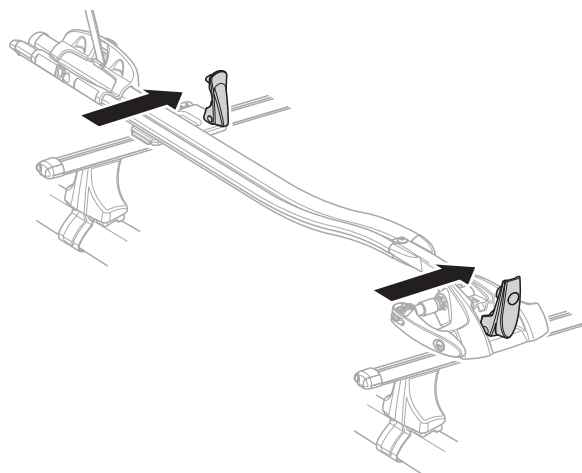
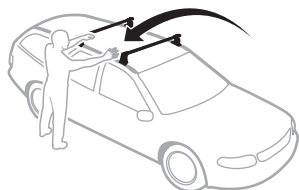
7

8

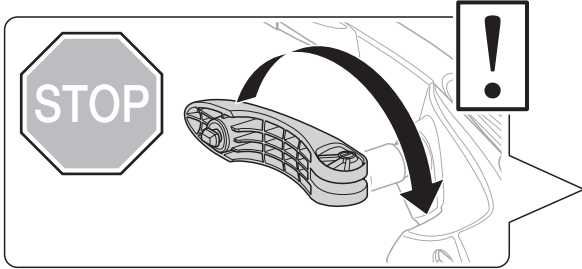
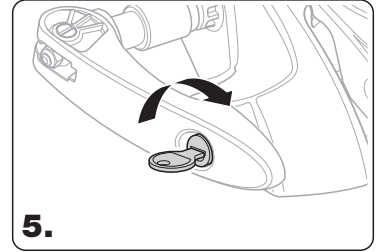
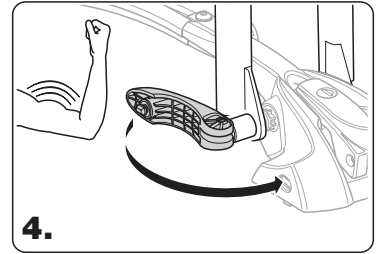
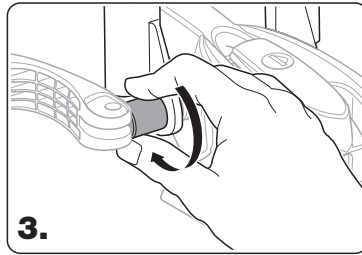
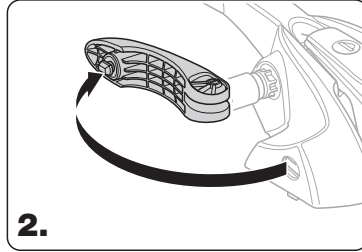
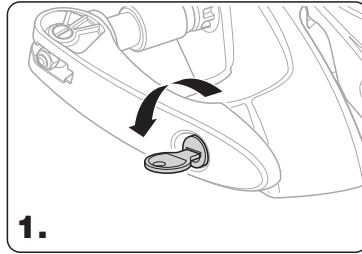
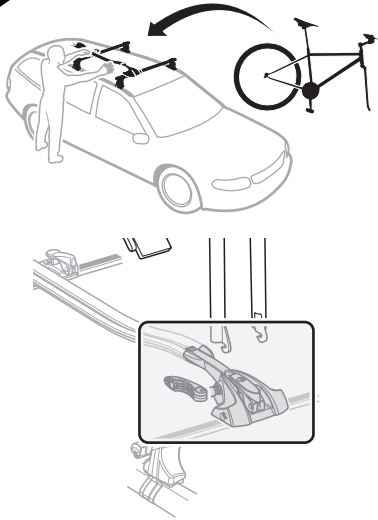

9

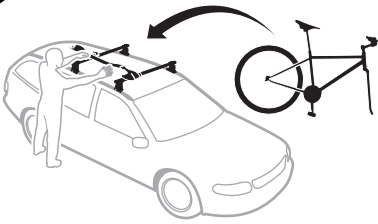

Fit Tips!

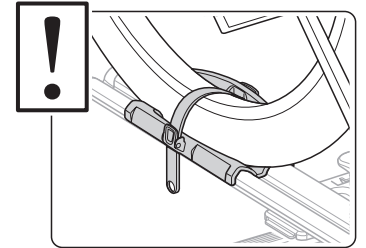
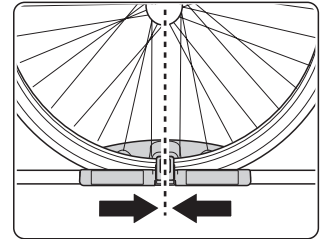
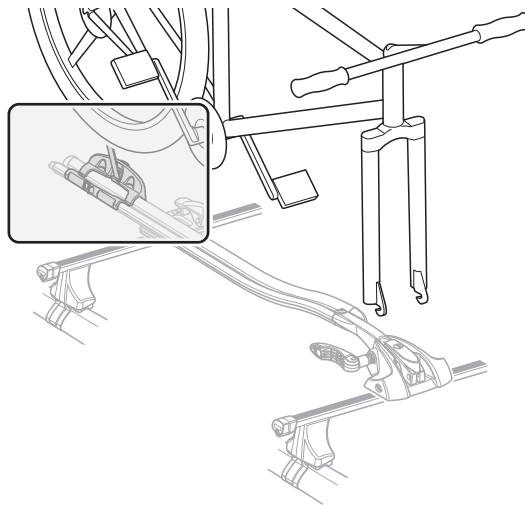
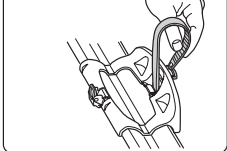

10

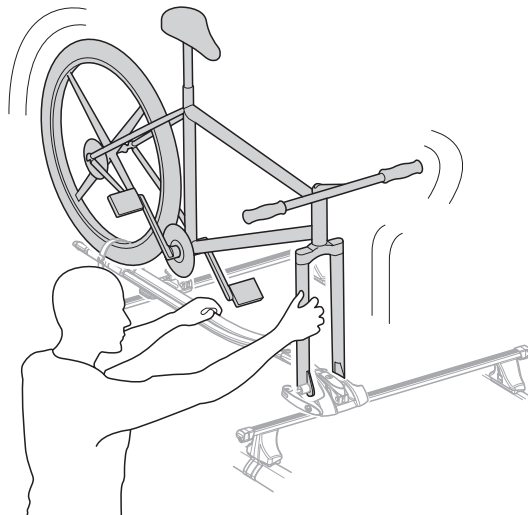
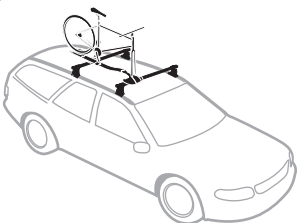

GB Left-hand fitting
D Montage links
F Montage côté gauche
NL Montage aan de linker kant
I Montaggio a sinistra
E Montaje a izquierda
PT Montagem do lado esquerdo

S Vänstermonterad
FIN Asennus vasemmalle
EST Vasakpoolne kinnitamine
LAT Kreisais stiprinājums
LIT Kairysis pritvirtinimas
PL Montaż z lewej
RU Установка на левую сторону

CZ Montáž z levé strany
SK Montáž na ľavej strane
SLO Pritrjevanje z leve strani
HR Montaža s lijeve strane
HU Bal oldalról szerelhető
GR Αριστερόστροφη τοποθέτηση

TR Sol elle montaj
中文 从左侧安装
日本語 左側の取り付け
한국어 왼손잡이용 장착
ไทย การติดตั้งสำหรับด้านซ้าย

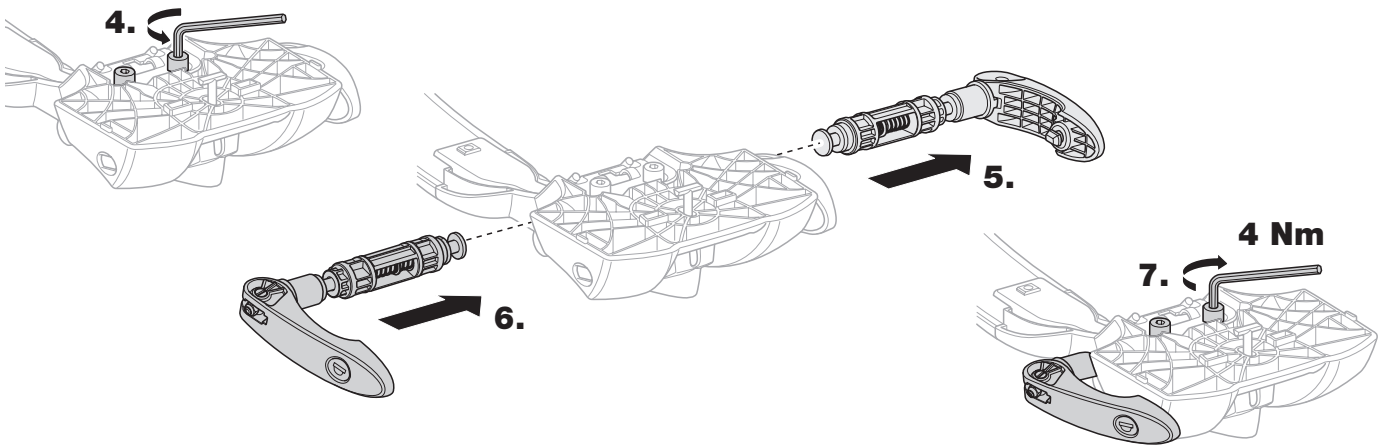
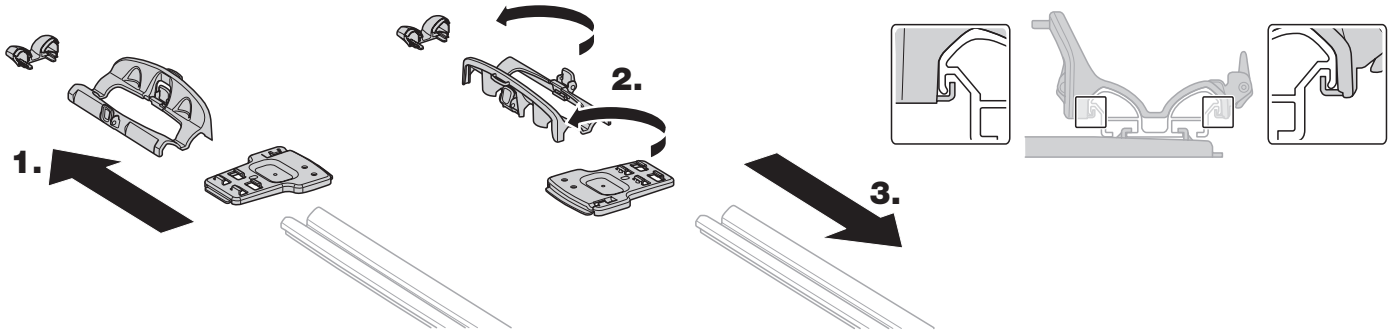
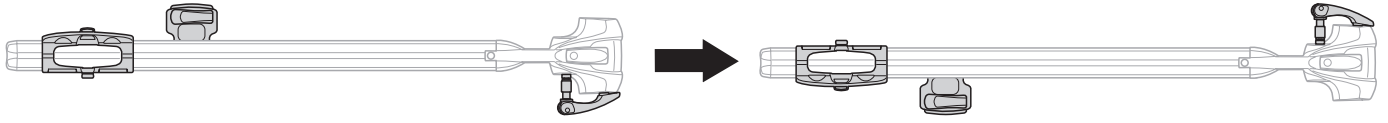

GB Adapter for Ø20 axle
D Adapter f. Tragachse m. Ø 20
F Adaptateur pour arbre de Ø 20 mm
NL Verloopstu voor Ø20-as
I Adattatore per assale Ø20
E Adaptador para eje de Ø20 mm
PT Adaptador para eixo de Ø20 mm
S Adapter för Ø20 mm axel
FIN Sovitin Ø 20 mm akselille

EST Adapter Ø20 teljele
LAT Ø20 mm ass adapteris
LIT Adapteris Ø20 mm ašiai
PL Złączka dla osi Ø20
RU Переходник для оси Ø20
CZ Adaptér pro osu Ø 20 mm
SK Adaptér na os Ø20 mm.
SLO Adapter za os Ø 20
HR Adapter za os od Ø20 mm

HU Adapter Ø20 mm-es tengelyhez
GR Προσαρμογέας άξονα Ø20 mm
TR Ø20 mm aks adaptörü
中文 Ø20 车轴适配器
日本語 直径 20mm アクセル用アダプター
한국어 Ø20 축용 어댑터
ไทย ตัวปรับโอด Ø20 มม.

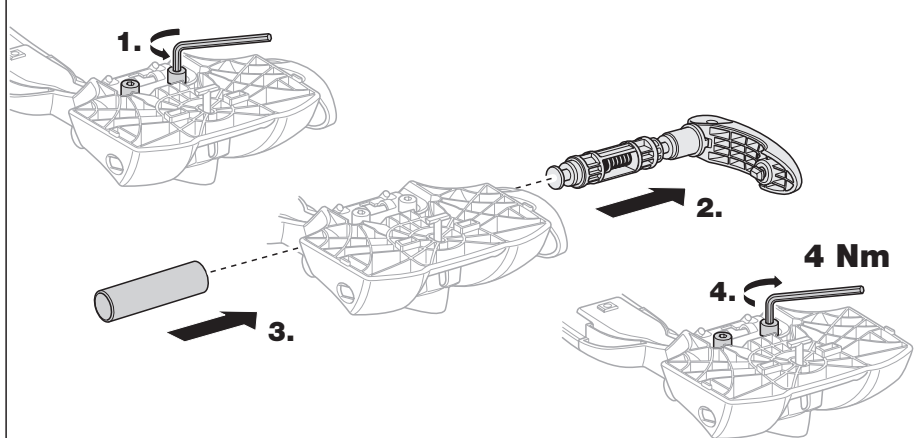
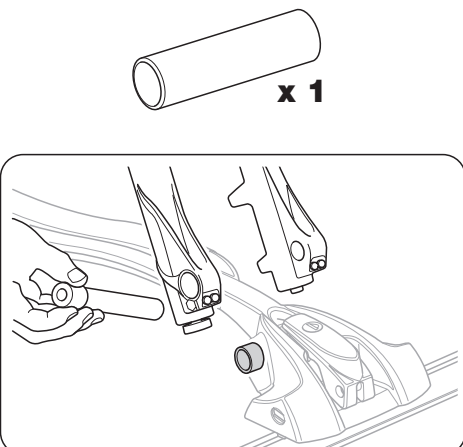

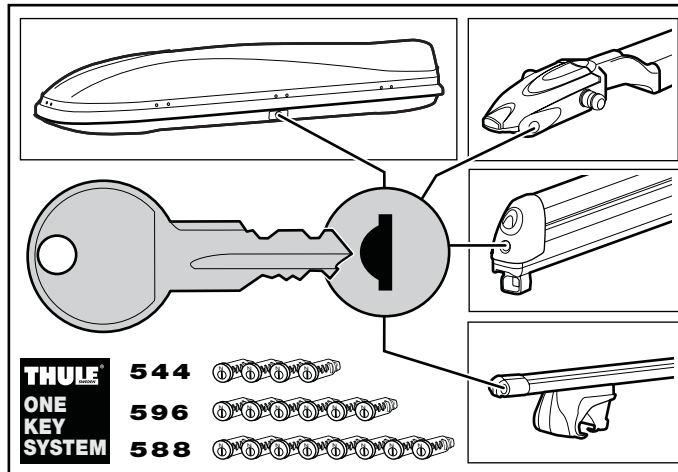
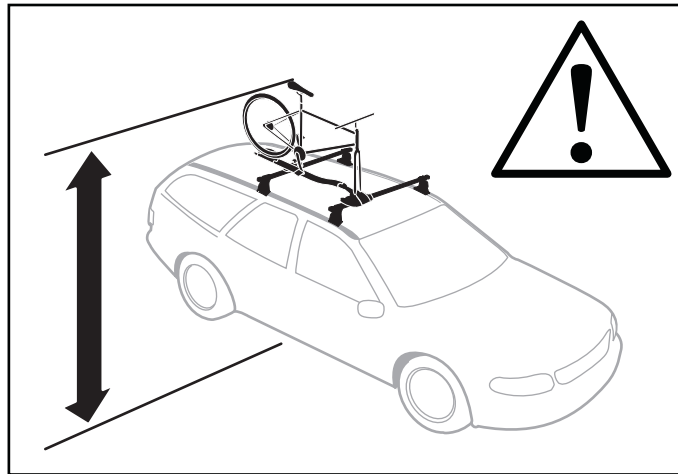
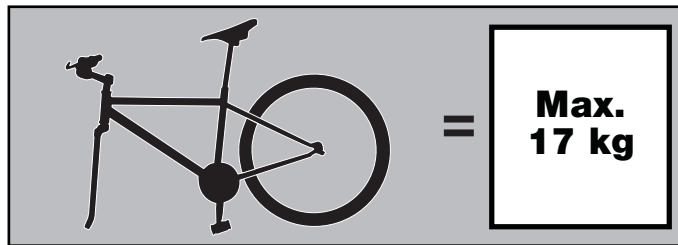

Se n^o houver instruções no seu idioma, entre em contato com os funcionários do estabelecimento para obter informações

Eğer talimatlar dilinizde basılı değilse, lütfen atölye personelinin bilgi isteyiniz.

Αν οι οδηγίες δεν εκτυπώνονται στη γλώσσα σας, παρακαλούμε ζητήστε πληροφορίες από το προσωπικό του καταστήματος.

ถ้าไม่มีคำแนะนำในภาษาของคุณ โปรดติดต่อพนักงานในร้านเพื่อขอข้อมูล

THULE[®]
SWEDEN

Box 69, 330 33 Hillerstorp, SWEDEN
www.thule.com